



# NEMA

## Full Line Motors



ZHEJIANG JINLONG ELECTRICAL MACHINERY STOCK CO.,LTD.

Add: No.999 West Jinqing Avenue, Jinqing Town,  
Luqiao District, Taizhou City, 318058, Zhejiang, China

(Tel): 86-576-82899777 82899779(Expt.)

86-576-82888000(Domestic)

(Fax):86-576-82899778 82899777(Expt.)

86-576-82899998(Domestic)

Http: //www.JLEM.cn

Http: //www.china-jinlong.com

E-mail: jinlong@china-jinlong.com

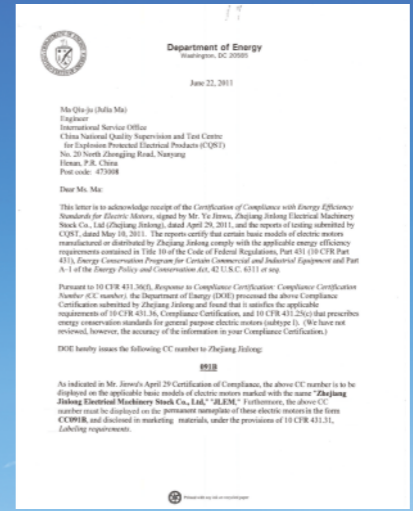
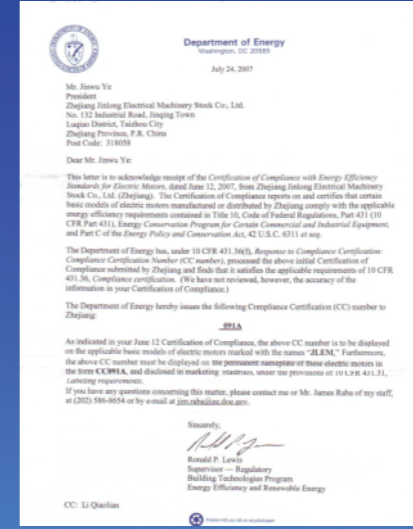

# PROFILE

JLEM, an expertise in motor technology research, development, manufacture, remanufacture, and energy solution, is vice president unit of China small & medium sized motor industry association, vice chairman unit of small & medium sized motor industry association of Zhejiang and Shanghai, and is a member of China rotating motor industry standard committee and a member of IEC standard working group.

With a powerful scientific and technical force, the most advanced production facilities in China motor industry, world-class testing conditions and consummate modernized management system, our company manufactures all the products in conformity with the IEC standards and all other standards of various countries, and the products have reached the advanced level of the same products in the world. It has obtained the ISO9001 international quality conformity, the USA BQR attestation, ISO14001 environment management system & clean production certification, GB/T28001-2001 occupational health and safety management system certificate, China CCC & CQC authentication and China Energy Conservation Product Certification (CECP), compliance certification number of department of energy US for NEMA EPACT and NEMA Premium, CSA energy mark for NEMA Premium, TUV & CE conformity for EU countries and UL approval from US and CSA approval from Canada, and the China quality license of motor production and explosion proof motor production, ATEX and IECEX approval for ex motors, CCS, GL and BV approval for marine motors. The JLEM branded motor has been granted the honor of "China Top Brand", and has been certified for the exemption from export inspection, and has been recognized as China National Credit Unit. Our company has been approved as a National hi-tech enterprise and listed as one of government purchase enterprise of energy saving products. Our high-efficiency motors have been listed in China Torch Plan and is on the first list of high efficiency motor of "Energy Saving Products Project that Benefiting People" issued by China National Development and Reform Commission, Ministry of Finance.

The company is specialized in manufacturing JM1(IE2), JM3(IE3) series cast iron three-phase motor, JL1(IE2), JL3(IE3) series aluminum three-phase electric motor, JMB1(IE2), JMB3(IE3) series explosion-proof motor, JLP1(IE2), JLP3(IE3) series pump motor, NEMA EPACT and Premium efficiency motor, inverter motor, marine motor, smoke-spill motor, single-phase motor, Y2, Y, YKK, YKS mid-hi volt motor, PM motor for injection machine, compressor, machine tool, server motor and drive, and various special and customized motors. The motors with more than 2500 varieties of specifications are available from 0.06Kw to 2500Kw. The company is one of the enterprises with the most complete categories among the same line in China.

Our various motors have been exported to over 80 countries and regions, such as Australia, Turkey, America, Canada, Russia, South America, European countries including Germany, Italy, UK and so on, widely used in the industries like compressor, pump, ventilator and reducer, enjoying high reputation at home and abroad. We are the leading export-oriented motor factory in China, with top export volume for the last consecutive years.

Making green products is our everlasting responsibility. Outstanding innovative idea, excellent product quality and faithful service attitude is our permanent objective and solemn promise.

# Connection Diagram

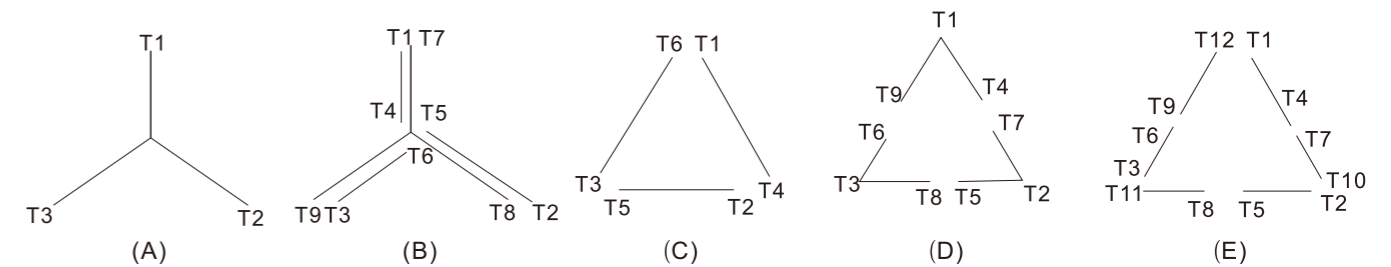

Voltage	230V/460V				460V		575V	
	230V		460V					
	L1,L2,L3	Tie together	Tie together	L1,L2,L3	L1,L2,L3	Tie together	L1,L2,L3	Tie together
143T-184T 213T-215T (6P)	(T1, T7) (T2, T8) (T3, T9) (B)	(T4, T5, T6)	T1, T2, T3 (B)	(T4, T7) (T5, T8) (T6, T9)	NO		T1, T2, T3	
213T-215T (2.4P) 254T-256T	(T1, T2, T3) (D)	(T1, T6, T7) (T2, T4, T8) (T3, T5, T9)	T1, T2, T3 (D)	(T4, T7) (T5, T8) (T6, T9)			(A)	
404 <sup>T</sup> S-286 <sup>T</sup> S 324 <sup>T</sup> S-365 <sup>T</sup> S 404 <sup>T</sup> S-505 <sup>T</sup> S	(T1, T2, T3) (E)	(T1, T6, T7, T12) (T2, T4, T8, T10) (T3, T5, T9, T11)	T1, T2, T3 (E)	(T4, T7)(T5, T8) (T6, T9)(T11, T12) (T2, T10)(T3, T11)	T1, T2, T3 (C)	(T1, T6) (T2, T4) (T3, T5)	T1, T2, T3 (C)	(T1, T6) (T2, T4) (T3, T5)



## A Corner of Workshop



## Mounting Type

T type -common mounted motor with feet  
 TC type -motor with or without feet. The mounting method of C type motor with feet should be MG1-403.Assembly symbols shall be as follows:

Note: Assembly symbols F-1,W-2,W-3,W-6, W-8,and C-2 show the same relative location for the terminal box, the mounting feet and the shaft-extension.

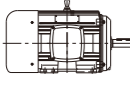
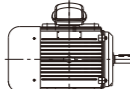
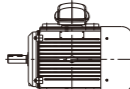
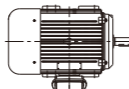
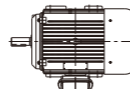
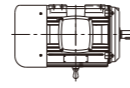
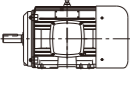
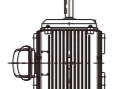
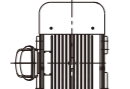
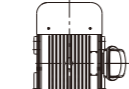
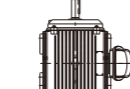
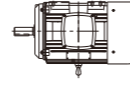
Floor mounting	Wall mounting					Ceiling mounting
 F-1	 W-1	 W-2	 W-3	 W-4		 C-1
 F-2	 W-5	 W-6	 W-7	 W-8		 C-2

## Bearing Size

Frame Size	Poles	BEARINGS	
		D.E	O.D.E
143/5T	2,4,6	6205 ZZ-C3	6205 ZZ-C3
182/4T	2,4,6	6306 ZZ-C3	6306 ZZ-C3
213/5T	2,4,6	6308 ZZ-C3	6308 ZZ-C3
254/6T	2,4,6	6309 ZZ-C3	6309 ZZ-C3
284/6T	2,4,6	6311 C3	6311 C3
324/6T	2,4,6	6312 C3	6312 C3
324/6TS	2,4,6	6312 C3	6312 C3
364/5T	2,4,6	6313 C3	6313 C3
364/5TS	2,4,6	6313 C3	6313 C3
404/5T	2,4,6	6317 C3	6313 C3
404/5TS	2,4,6	6313 C3	6313 C3
444/445T	2,4,6	6319 C3	6314 C3
444/445TS	2,4,6	6314 C3	6314 C3
447/449T	2,4,6	6319 C3	6314 C3
447/449TS	2,4,6	6314 C3	6314 C3
500TY/500LY	2,4,6	Nu320	6319 C3

## Catalogue Numbering Reference

### General Purpose Motors

Example

**PE 50 4 T 0 1**

First 2 letters designate the motor line

- PE - Premium Efficient Motors
- HE - High efficient cast iron frame motors
- RT - Three phase roll steel housing motors
- RS - Single phase roll steel housing motors
- AE - High efficient aluminum frame motors
- AP - Premium efficient aluminum frame motors

Next 2-3 Number designate the horsepower

Next Number designate the speed

Next Letter designate the enclosure

- T - TEFC
- D - ODP

Next Number designate the Mounting

- 0 - Foot Mount
- 1 - C Face , Footed
- 2 - C Face , Footless

# Catalogue Numbering Reference

## Special Purpose Motors

### Part:1

First 2-3 letters designate the motor line

- CC - Close-coupled pump motors
- EX - Explosion proof motors
- SS - Stainless steel motors

Next 2-3 Number designate the horsepower

Next Number designate the speed

Next Number designate the Mounting

- M - JM
- P - JP
- 0 - Foot Mount
- 1 - C Face , Footed
- 2 - C Face , Footless

Last Number designate the sequence number

### Part:2

First 2 letters designate the motor line

- CU - Crusher Duty Motors
- MV - Medium voltage motors
- CO - Air compressor motors

Next 2-3 Number designate the horsepower

Next Number designate the speed

Last Number designate the sequence number

### Part:3

First 3 letters designate the motor line

- OWP - Oil well pump motors

Next 2-3 Number designate the horsepower

Last Number designate the sequence number

## CONTENTS

### General Purpose Motors

#### Single Phase Motors

TEFC .....	01
ODP .....	03

#### Premium efficient Motors

Cast Iron Frame TEFC .....	05
Cast Iron Frame ODP .....	11
Aluminum Frame TEFC .....	13

#### High Efficient Motors

Cast Iron Frame .....	16
Roll Steel Housing TEFC .....	20
Roll Steel Housing ODP .....	22
Aluminum Frame .....	24

#### C Face Motors

Single phase	
TEFC .....	26
ODP .....	28

#### Three phase

Premium efficient Motors	
TEFC .....	30
ODP .....	32

#### High Efficient Motors

Cast Iron Frame .....	34
Roll Steel Housing TEFC .....	37
Roll Steel Housing ODP .....	39
Aluminum Frame .....	41

#### Severe Duty Motors

Medium Voltage Motors .....	43
Crusher Motors .....	45
IEEE-841 Motors .....	47

#### Explosion Proof Motors

50

### Special Purpose Motors

Close Coupled Pump Motors .....	54
Oil Well Pump Motors .....	57
Washdown Duty Motors .....	59
Air compressor Motors .....	61
Swimming Pool Motors .....	62
Farm Duty Single Phase Motors .....	66
Belted Fan & Blower Motors .....	68
Single Phase Auger Motors .....	71

# Single Phase Roll Steel Motors

## Foot Mount TEFC

**NEMA**  
Full Line Motors

### Applications:

Designed for pumps, fans, compressors, material handling and other general purpose applications in damp dusty or dirty environment.

### Features:

Class F Insulation  
Rolled Steel Frame  
Aluminum End Shields  
Design B

Double Shielded Bearings  
40 °C Ambient  
High Efficient



# Single Phase Roll Steel Motors

## Foot Mount TEFC

### Mounting and overall dimensions

## TEFC 48-215T

HP	RPM	Voltage	Frame	Catalog Number	SF	Full load Eff.	Full load Amps	Ship WT. (lbs.)
1/4	3600	115/230	48	RS142T01	1	61	3.4/1.7	17
	1800	115/230	48	RS144T01	1	65	4.2/2.1	19
1/3	3600	115/230	48	RS132T01	1.15	65	4.2/2.1	21
	3600	115/230	56	RS132T02	1.35	58	5.2/2.6	23
	1800	115/230	48	RS134T01	1.15	68	5.2/2.6	23
1/2	1800	115/230	56	RS134T02	1	65	4.8/2.4	22
	3600	115/230	48	RS122T01	1.15	69	5.8/2.9	23
	3600	115/230	56	RS122T02	1.15	65	6.6/3.3	26
3/4	1800	115/230	48	RS124T01	1.15	71	7.2/3.6	26
	1800	115/230	56	RS124T02	1.25	69	6.4/3.2	23
	3600	115/230	56	RS342T01	1.15	70	8.6/4.3	30
1	1800	115/230	56	RS344T01	1	73	8.8/4.4	25
	3600	115/230	56	RS12T01	1.15	73	10.8/5.4	36
1 1/2	1800	115/230	56	RS14T01	1.15	75	11.2/5.6	40
	3600	115/230	143T	RS322T01	1.15	74	13.8/6.9	45
2	1800	115/230	145T	RS344T01	1	76	13.4/6.7	48
	3600	115/230	56	RS22T01	1.15	76	18.0/9.0	40
	3600	115/230	145T	RS22T02	1.15	76	18/9	51
3	1800	115/230	56	RS24T01	1.15	77	17.8/8.9	75
	1800	115/230	145T	RS24T02	1.15	77	17.8/8.9	77
	3600	230	182T	RS32T01	1	78	13.1	81
5	1800	230	182T	RS34T01	1	79	13	75
	3600	230	184T	RS52T01	1	80	21.3	97
7 1/2	1800	230	184T	RS54T01	1	82	20.8	90
	3600	230	213T	RS72T01	1	83	30.9	86
10	1800	230	213T	RS74T01	1	84	30.5	126
	3600	230	215T	RS102T01	1	85	40.2	130
	1800	230	215T	RS104T01	1	86	39.7	135

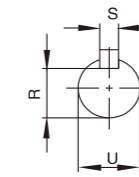
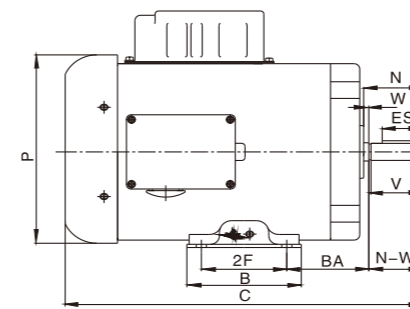

**48-56T**

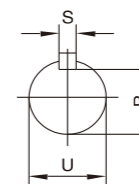
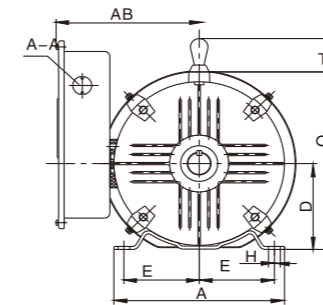
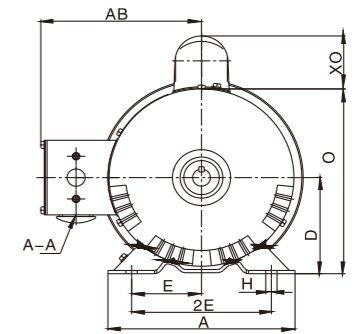

**180-210T**

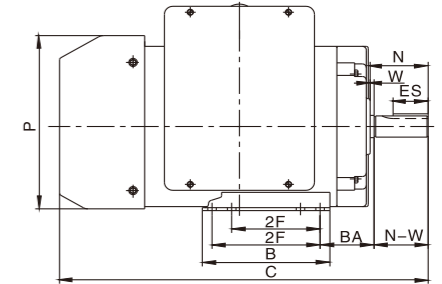

Frame size	AB	BA	MAX A	MAX B	C	D	E	2F	H	N	N-W	O	P	R	S	U	MIN V	MIN ES	MIN AA
48	5.3	2.5	6	3.8	10	3.0	2.12	2.75	0.34	1.62	1.5	5.83	5.66	0.453		0.5	1.125		1/2
56	5.6	2.75	6.5	4.2	12.7	3.5	2.44	3	0.34	2.4	1.88	6.7	7.08	0.517	0.188	0.625	1.5	1.41	1/2
143T								4											
145T	5.6	2.25	7	6.18	14.6	3.5	2.75	5	0.34	2.46	2.25	6.7	7.08	0.771	0.188	0.875	2	1.41	3/4
182T								4.5											
184T	7.2	2.75	8.5	6.5	18.8	4.5	3.75	5.5	0.41	2.98	2.75	9.25	9.25	0.986	0.25	1.125	2.5	1.78	3/4
213T								5.5											
215T	7.5	3.5	9.5	8	20.5	5.25	4.25	7.0	0.41	3.66	3.38	9.84	10	1.201	0.312	1.375	3.12	2.41	1

Single Phase Motors • Premium efficient Motors • High efficient Motors • C Face Motors • Severe Duty Motors • IEEF-841 Motors • Explosion Proof Motors • Special Purpose Motors • Farm Duty Single Phase Motors • Belted Fan & Blower Motors • Single Phase Auger Motors

Single Phase Motors • Premium efficient Motors • High efficient Motors • C Face Motors • Severe Duty Motors • IEEF-841 Motors • Explosion Proof Motors • Special Purpose Motors • Farm Duty Single Phase Motors • Belted Fan & Blower Motors • Single Phase Auger Motors

# Single Phase Roll Steel Motors

## Foot Mount ODP

### Applications:

Designed for pumps, fans, compressors, material handling and other general purpose applications where contaminants are minimal.

### Features:

Class F Insulation  
Rolled Steel Frame  
Aluminum End Shields  
Design B

Double Shielded Bearings  
40°C Ambient  
High Efficient



HP	RPM	Voltage	Frame	Catalog Number	SF	Full load Eff.	Full load Amps	Ship WT. (lbs.)
1/4	3600	115/230	48	RS142D01	1.35	58	3.8/1.9	17
	1800	115/230	48	RS144D01	1.35	61	4.6/2.3	19
1/3	3600	115/230	48	RS132D01	1.35	62	4.8/2.4	21
	3600	115/230	56	RS132D02	1.35	58	5.2/2.6	23
	1800	115/230	48	RS134D01	1.35	65	5.4/2.7	23
	1800	115/230	56	RS134D02	1.35	65	4.8/2.4	22
1/2	3600	115/230	48	RS122D01	1.25	68	6.2/3.1	23
	3600	115/230	56	RS122D02	1.25	65	6.6/3.3	26
	1800	115/230	48	RS124D01	1.25	69	7.6/3.8	26
3/4	1800	115/230	56	RS124D02	1.25	69	6.4/3.2	23
	3600	115/230	56	RS342D01	1.25	70	8.6/4.3	30
1	1800	115/230	56	RS344D01	1.25	73	8.8/4.4	25
	3600	115/230	56	RS12D01	1.25	73	10.8/5.4	36
1 1/2	1800	115/230	56	RS14D01	1.15	75	11.2/5.6	40
	3600	115/230	143T	RS322D01	1.15	74	13.8/6.9	45
2	1800	115/230	145T	RS344D01	1.15	76	13.4/6.7	48
	3600	115/230	56	RS22D01	1.15	76	18.0/9.0	40
	3600	115/230	145T	RS22D02	1.15	76	18/9	51
	1800	115/230	56	RS24D01	1.15	77	17.8/8.9	75
3	1800	115/230	145T	RS24D02	1.15	77	17.8/8.9	76
	3600	230	182T	RS32D01	1.15	78	13.1	81
5	1800	230	182T	RS34D01	1.15	79	13	78
	3600	230	184T	RS52D01	1.15	80	21.3	97
7 1/2	1800	230	184T	RS54D01	1.15	82	20.8	90
	3600	230	213T	RS72D01	1.15	83	30.9	86
10	1800	230	213T	RS74D01	1.15	84	30.5	126
	3600	230	215T	RS102D01	1.15	85	40.2	132
	1800	230	215T	RS104D01	1.15	86	39.7	135

# NEMA

## Full Line Motors

# Single Phase Roll Steel Motors

## Foot Mount ODP

### Mounting and overall dimensions

## ODP 48-215T

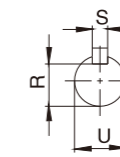
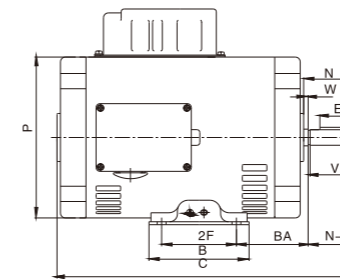

48-56T

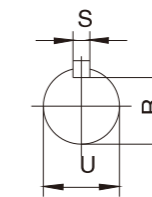
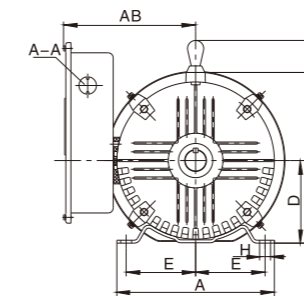
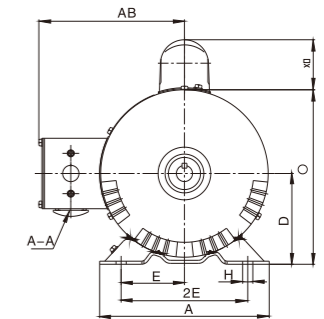

180-210T

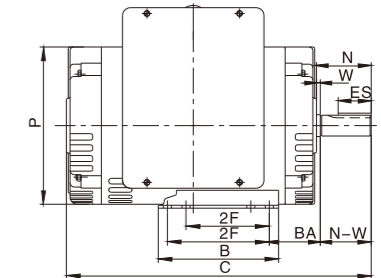

Frame size	AB	BA	MAX A	MAX B	C	D	E	2F	H	N	N-W	O	P	R	S	U	MIN V	MIN ES	MIN AA
48	5.3	2.5	6	3.8	10	3.	2.12	2.75	0.34	1.62	1.5	5.83	5.66	0.453		0.5	1.125		1/2
56	5.6	2.75	6.5	4.2	11.4	3.5	2.44	3	0.34	2.4	1.88	6.7	6.45	0.517	0.188	0.625	1.5	1.41	1/2
143T								4											
145T	5.6	2.25	7	6.18	13.3	3.5	2.75	5	0.34	2.46	2.25	6.7	6.45	0.771	0.188	0.875	2	1.41	3/4
182T								4.5											
184T	7.2	2.75	8.5	6.5	16.5	4.5	3.75	5.5	0.41	2.98	2.75	9.25	8.5	0.986	0.25	1.125	2.5	1.78	3/4
213T								5.5											
215T	7.5	3.5	9.5	8	18	5.25	4.25	7.0	0.41	3.66	3.38	9.84	9	1.201	0.312	1.375	3.12	2.41	1



# Premium Efficient Cast Iron Motors

Foot Mount TEFC

## Applications:

General purpose use on pumps, fans, blowers, compressors, conveyors, and other industrial machinery installed in damp, dusty. Or dirty environments. Additionally, cast iron frame motors may be suitable for the process industries.

## Features:

Service Factor 1.15  
Premium efficient  
Class F insulation

Cast Iron frame, end shield  
Maximum 40°C ambient temperature  
Design B



HP	RPM	Voltage	Frame	Catalog Number	Full Eff. 100%	Full Amps 460V	Ship WT. (lbs.)
1	1800	208-230/460V	143T	PE14T01	85.5	1.43	54
	1200	208-230/460V	145T	PE16T01	82.5	1.73	56
1.5	3600	208-230/460V	143T	PE322T01	84	1.98	45
	1800	208-230/460V	145T	PE324T01	86.5	2	56
	1200	208-230/460V	182T	PE326T01	87.5	2.39	79
2	3600	208-230/460V	145T	PE22T01	85.5	2.65	52
	1800	208-230/460V	145T	PE24T01	86.5	2.63	58
	1200	208-230/460V	184T	PE26T01	88.5	3.23	97
3	3600	208-230/460V	182T	PE32T01	86.5	3.68	99
	1800	208-230/460V	182T	PE34T01	89.5	3.9	99
	1200	208-230/460V	213T	PE36T01	89.5	4.41	134
5	3600	208-230/460V	184T	PE52T01	88.5	5.76	114
	1800	208-230/460V	184T	PE54T01	89.5	6.4	108
	1200	208-230/460V	215T	PE56T01	89.5	6.83	175
7.5	3600	208-230/460V	213T	PE72T01	91	8.63	134
	1800	208-230/460V	213T	PE74T01	91.7	9.29	165
	1200	208-230/460V	254T	PE76T01	91	9.73	282

**NEMA**  
Full Line Motors

# Premium Efficient Cast Iron Motors

Foot Mount TEFC

HP	RPM	Voltage	Frame	Catalog Number	Full Eff. 100%	Full Amps 460V	Ship WT. (lbs.)
10	3600	208-230/460V	215T	PE102T01	90.2	11.5	173
	1800	208-230/460V	215T	PE104T01	91.7	12.6	172
	1200	208-230/460V	256T	PE106T01	91	13.3	316
15	3600	208-230/460V	254T	PE152T01	91	16.9	280
	1800	208-230/460V	254T	PE154T01	92.4	18	291
	1200	208-230/460V	284T	PE156T01	91.7	17.3	360
20	3600	208-230/460V	256T	PE202T01	91	22.9	313
	1800	208-230/460V	256T	PE204T01	93	24.4	324
	1200	208-230/460V	286T	PE206T01	91.7	24.1	503
25	3600	208-230/460V	284TS	PE252T01	91.7	28.4	353
	1800	208-230/460V	284T	PE254T01	93.6	29.5	481
	1200	208-230/460V	324T	PE256T01	93	30.5	605
30	3600	208-230/460V	286TS	PE302T01	91.7	33.4	428
	1800	208-230/460V	286T	PE304T01	93.6	35.1	525
	1200	208-230/460V	326T	PE306T01	93	35.8	673
40	3600	208-230/460V	324TS	PE402T01	92.4	45.8	561
	1800	208-230/460V	324T	PE404T01	94.1	48.3	640
	1200	208-230/460V	364T	PE406T01	94.1	47.1	1076
50	3600	208-230/460V	326TS	PE502T01	93	55.5	607
	1800	208-230/460V	326T	PE504T01	94.5	60.6	662
	1200	208-230/460V	365T	PE506T01	94.1	58	1127
60	3600	208-230/460V	364TS	PE602T01	93.6	68.3	992
	1800	208-230/460V	364T	PE604T01	95	68.4	1036
	1200	208-230/460V	404T	PE606T01	94.5	70.4	1346





# Premium Efficient Cast Iron Motors

## Foot Mount ODP



### Applications:

Designed for pumps, fans, compressors, material handling, and other general purpose applications where contaminants are minimal.

### Features:

Service Factor 1.15  
 Premium efficient  
 Class F insulation

Cast Iron frame, end shield  
 Maximum 40°C ambient temperature  
 Design B

HP	RPM	Voltage	Frame	Catalog Number	Full Eff. 100%	Full Amps 460V	Ship WT. (lbs.)
15	1800	208-230/460V	<b>254T</b>	PE154D01	93	18.6	234
	1200	208-230/460V	<b>284T</b>	PE156D01	92.4	18.5	330
20	3600	208-230/460V	<b>254T</b>	PE202D01	91	24.6	205
	1800	208-230/460V	<b>256T</b>	PE204D01	93	25.3	291
20	1200	208-230/460V	<b>286T</b>	PE206D01	92.4	26.0	372
	3600	208-230/460V	<b>256T</b>	PE252D01	91.7	28.8	269
25	1800	208-230/460V	<b>284TS</b>	PE254D01	93.6	29.2	382
	1800	208-230/460V	<b>284T</b>	PE254D02	93.6	29.2	382
25	1200	208-230/460V	<b>324T</b>	PE256D01	93	31.0	478
	3600	208-230/460V	<b>284TS</b>	PE302D01	91.7	31.1	373
30	1800	208-230/460V	<b>286TS</b>	PE304D01	94.1	35.4	459
	1800	208-230/460V	<b>286T</b>	PE304D02	94.1	35.4	459
30	1200	208-230/460V	<b>326T</b>	PE306D01	93.6	37.0	474
	3600	208-230/460V	<b>286TS</b>	PE402D01	92.4	37.1	457
40	1800	208-230/460V	<b>324TS</b>	PE404D01	94.1	45.7	574
	1800	208-230/460V	<b>324T</b>	PE404D02	94.1	45.7	574
40	1200	208-230/460V	<b>364T</b>	PE406D01	94.1	50.0	827
	3600	208-230/460V	<b>324TS</b>	PE502D01	93	50.2	541
50	1800	208-230/460V	<b>326TS</b>	PE504D01	94.5	57.3	618
	1800	208-230/460V	<b>326T</b>	PE504D02	94.5	57.3	618
50	1200	208-230/460V	<b>365T</b>	PE506D01	94.1	62.0	867
	3600	208-230/460V	<b>326TS</b>	PE602D01	93.6	65	627
60	1800	208-230/460V	<b>364TS</b>	PE604D01	95	68	935
	1800	208-230/460V	<b>364T</b>	PE604D02	95	68	935
60	1200	208-230/460V	<b>404T</b>	PE606D01	94.5	72	1153
	3600	208-230/460V	<b>364TS</b>	PE752D01	93.6	81.5	805
75	1800	208-230/460V	<b>365TS</b>	PE754D01	95	85.5	935
	1800	208-230/460V	<b>365T</b>	PE754D02	95	85.5	935
75	1200	208-230/460V	<b>405T</b>	PE756D01	94.5	88.0	1114
	3600	208-230/460V	<b>365TS</b>	PE1002D01	93.6	111	935
100	1800	208-230/460V	<b>404TS</b>	PE1004D01	95.4	115	1207
	1800	208-230/460V	<b>404T</b>	PE1004D02	95.4	115	1207
100	1200	208-230/460V	<b>444T</b>	PE1006D01	95	123	1472
	3600	460V	<b>404TS</b>	PE1252D01	94.1	132	1401
125	1800	460V	<b>405TS</b>	PE1254D01	95.4	141	1207
	1800	460V	<b>405T</b>	PE1254D02	95.4	141	1207
125	1200	460V	<b>445T</b>	PE1256D01	95	146	1573
	3600	460V	<b>405TS</b>	PE1502D01	94.1	159	1141
150	1800	460V	<b>444TS</b>	PE1504D01	95.8	166	1609
	1800	460V	<b>444T</b>	PE1504D02	95.8	166	1609
150	1200	460V	<b>445T</b>	PE1506D01	95.4	176	1789
	3600	460V	<b>444TS</b>	PE2002D01	95	220	1713
200	1800	460V	<b>445TS</b>	PE2004D01	95.8	223	1916
	1800	460V	<b>445T</b>	PE2004D02	95.8	223	1916
200	1200	460V	<b>447T</b>	PE2006D01	95.4	234	1837
	250	1800	460V	<b>445T</b>	PE2504D01	95.8	280
300	1800	460V	<b>445T</b>	PE3004D01	95.8	335	2010

Note: 1/4-10HP to page 15.

# NEMA

## Full Line Motors

### Premium Efficient Cast Iron Motors

Foot Mount ODP

Mounting and overall dimensions **254/6T-404/5T, 444/5T**

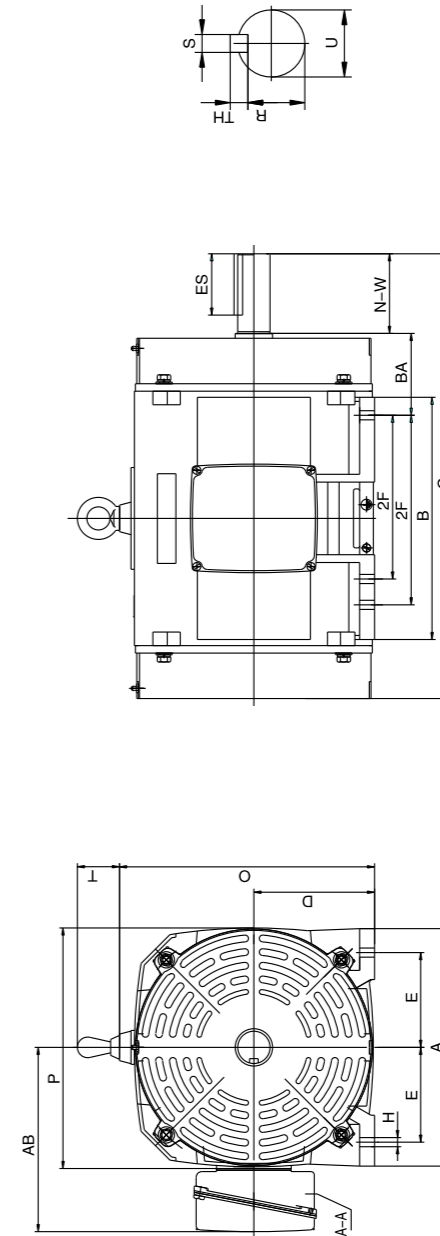

FRAME NO.	A	B	C	D	E	2F	H	P	O+T	A-A	AB	BA	N-W	ES	S	TH	R	U
<b>254/6T</b>	12.2	9.84/11.57	20.67/22.4	6.25	5	8.25/10	4-φ0.35	12.8	14.55	φ2.05	11.1	4.25	4	2.875	0.375	0.375	1.416	1.625
<b>284/6T</b>	12.76	11.26/12.76	23.82/25.32	7	5.5	9.5/11	4-φ0.53	14.76	16.84	φ2.84	13.18	4.75	4.62	3.25	0.5	0.5	1.591	1.875
<b>324/6T</b>	14.88	12.68/14.17	26.26/27.76	8	6.25	10.5/12	4-φ0.66	16.69	18.82	φ2.84	14.09	5.25	5.25	3.875	0.5	0.5	1.845	2.125
<b>364/5T</b>	16.38	13.43/14.41	29.13/30.13	9	7	11.25/12.25	4-φ0.66	18.31	21.05	φ3.58	16.33	5.88	5.88	4.25	0.625	0.625	2.021	2.375
<b>404/5T</b>	19.69	14.96/16.54	33.1/34.6	10	8	12.25/13.75	4-φ0.81	20.24	23.78	φ4.64	20.08	6.62	7.25	5.625	0.75	0.75	2.45	2.875
<b>444/5TT</b>	22.05	17.32/19.29	37.7/39.7	11	9	14.5/16.5	4-φ0.81	22.05	26.35	φ4.64	20.86	7.5	8.5	6.91	0.875	0.875	2.88	3.375

# Premium Efficient Aluminum Motors

## Foot Mount TEFC



### Applications:

General purpose use on pumps, fans, blowers, compressors, conveyors, reducers and other industrial machinery .

### Features:

- Service Factor 1.15
- Premium efficient
- Class F insulation
- TEFC enclosure
- Removable Base
- Aluminum frame, end shield
- Maximum 40°C ambient temperature
- Design B
- D Flange Available
- Low noise

HP	RPM	Voltage	Frame	Catalog Number	Full Eff. 100%	Full Amps 460V	Ship WT. (lbs.)
1	1800	208-230/460V	<b>143T</b>	AP14T01	85.5	1.43	36
	1200	208-230/460V	<b>145T</b>	AP16T01	82.5	1.73	38
1.5	3600	208-230/460V	<b>143T</b>	AP322T01	84	1.98	28
	1800	208-230/460V	<b>145T</b>	AP324T01	86.5	2	32
	1200	208-230/460V	<b>182T</b>	AP326T01	87.5	2.39	59
	3600	208-230/460V	<b>145T</b>	AP22T01	85.5	2.65	35
2	1800	208-230/460V	<b>145T</b>	AP24T01	86.5	2.63	33
	1200	208-230/460V	<b>184T</b>	AP26T01	88.5	3.23	73
3	3600	208-230/460V	<b>182T</b>	AP32T01	87.5	3.68	41
	1800	208-230/460V	<b>182T</b>	AP34T01	89.5	3.9	64
	1200	208-230/460V	<b>213T</b>	AP36T01	89.5	4.41	95
	3600	208-230/460V	<b>184T</b>	AP52T01	89.5	5.76	68
5	1800	208-230/460V	<b>184T</b>	AP54T01	89.5	6.4	72
	1200	208-230/460V	<b>215T</b>	AP56T01	89.5	6.83	97
7.5	3600	208-230/460V	<b>213T</b>	AP72T01	91	8.63	102
	1800	208-230/460V	<b>213T</b>	AP74T01	91.7	9.29	108
	1200	208-230/460V	<b>254T</b>	AP76T01	91	9.73	170
	3600	208-230/460V	<b>215T</b>	AP102T01	91.7	11.5	133
10	1800	208-230/460V	<b>215T</b>	AP104T01	91.7	12.6	117
	1200	208-230/460V	<b>256T</b>	AP106T01	91	13.3	173
15	3600	208-230/460V	<b>254T</b>	AP152T01	91.7	16.9	150
	1800	208-230/460V	<b>254T</b>	AP154T01	92.4	18	138
	1200	208-230/460V	<b>284T</b>	AP156T01	91.7	17.3	234
	3600	208-230/460V	<b>256T</b>	AP202T01	92.4	22.9	181
20	1800	208-230/460V	<b>256T</b>	AP204T01	93	24.4	183
	1200	208-230/460V	<b>286T</b>	AP206T01	91.7	24.1	286
25	3600	208-230/460V	<b>284TS</b>	AP252T01	93	28.4	255
	1800	208-230/460V	<b>284T</b>	AP254T01	93.6	29.5	267
	1200	208-230/460V	<b>324T</b>	AP256T01	93	30.5	380
	3600	208-230/460V	<b>286TS</b>	AP302T01	93	33.4	289
30	1800	208-230/460V	<b>286T</b>	AP304T01	93.6	35.1	291
	1200	208-230/460V	<b>326T</b>	AP306T01	93	35.8	428

# NEMA

## Full Line Motors

# Premium Efficient Aluminum Motors

## Foot Mount TEFC

### Mounting and overall dimensions 143T-286T

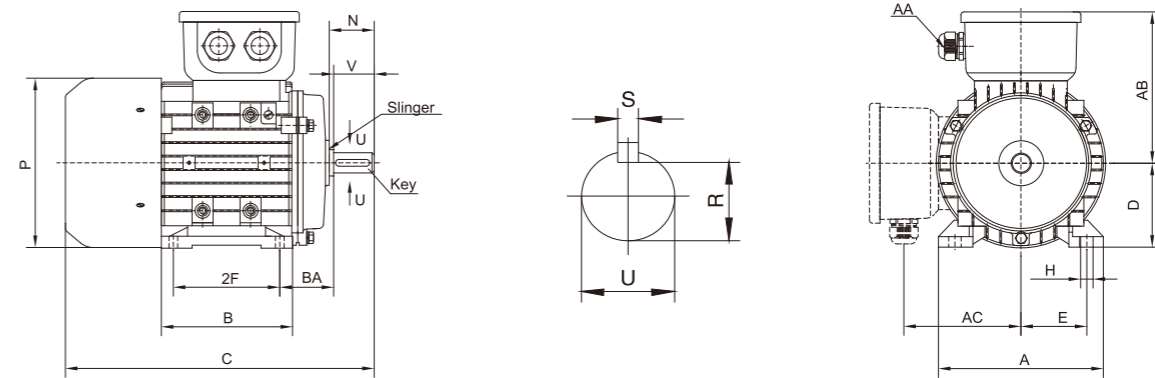

NEMA Frame	A	B	C	D	E	2F	H	Es	N	O	P	S	R	U	N-W	AA	AB	AC	BA
143T		4.9	13.2			4													
145T	6.8	5.9	14.1	3.5	2.75	5	0.38	1.41	2.5	7.48	7.5	0.188	0.771	0.875	2.25	0.75	5.5	4.5	2.25
182T						4.5													
184T	8.62	6.5	18	4.5	3.75	5.5	0.41	1.78	2.81	9.23	8.7	0.25	0.986	1.125	2.75	0.75	7.12	5.75	2.75
213T			19			5.5													
215T	9.62	8.12	20.4	5.25	4.25	7	0.41	2.41	3.88	10.99	10.2	0.312	1.201	1.375	3.38	1	9.22	7.43	3.5
254T			23.6			8.25													
256T	11.5	11.5	25.3	6.25	5	10	0.53	2.91	4.2	12.96	12.4	0.375	1.418	1.625	4	1.25	10.48	8.66	4.25
284T			29			9.5													
286T	12.76	12.75	30.5	7	5.5	11	0.53	3.28	4.88	14.74	14	0.5	1.591	1.875	4.63	1.5	12.46	10.14	4.75

**Premium Efficient Aluminum Motors**  
C Face Mount TEFC

**Mounting and overall dimensions 143TC-286TC**

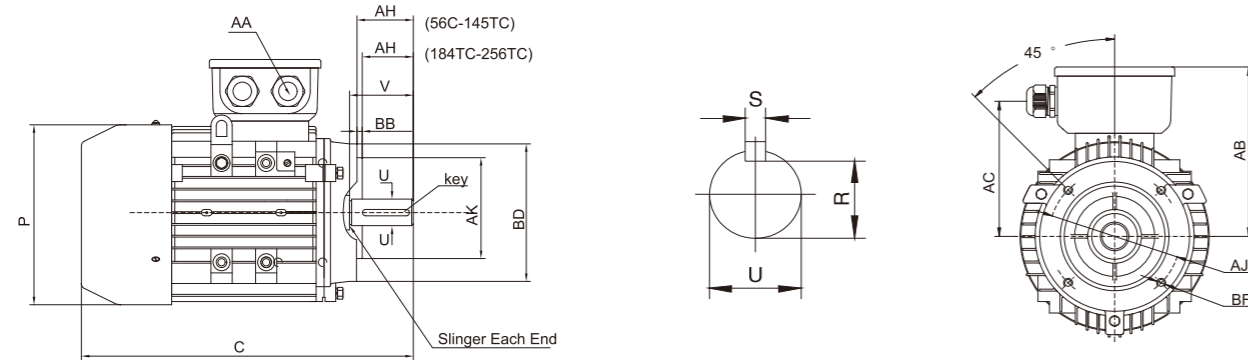

NEMA Frame	Key	C	O	P	S	R	U	N-W	AA	AB	AC	AH	AJ	AK	BB	BC	BD	Tap B F
143TC		13.2																
145TC	1.41	14.1	7.48	7.5	0.188	0.771	0.875	2.12	0.75	6.38	5	2.25	5.875	4.5	0.16	0.12	6.51	3/8-16
182TC																		
184TC	1.78	18	9.23	8.7	0.25	0.986	1.125	2.62	0.75	7.12	5.75	2.75	7.25	8.5	0.25	0.12	9	1/2-13
213TC		19																
215TC	2.41	20.4	10.99	10.2	0.312	1.201	1.375	3.38	1	9.22	7.43	3.15	7.25	8.5	0.25	0.25	9	1/2-13
254TC		23.6																
256TC	2.91	25.3	12.96	12.4	0.375	1.418	1.625	4	1.25	10.48	8.66	3.75	7.25	8.5	0.25	0.25	10	1/2-13
284TC		29																
286TC	3.28	30.5	14.74	14	0.5	1.591	1.875	4.63	1.5	12.46	10.14	4.38	9	10.5	0.25	0.25	11.25	1/2-13

**EISA-Compliant High Efficient Cast Iron Motors**  
Foot Mount TEFC

**Applications:**

General purpose use on pumps, fans, blowers, compressors, conveyors, and other industrial machinery installed in damp, dusty. Or dirty environments. Additionally, cast iron frame motors may be suitable for the process industries.



**Features:**

Service Factor 1.15  
EISA-Compliant High efficient  
Class F insulation

Cast Iron frame, end shield  
Maximum 40°C ambient temperature  
Design C high torque

HP	RPM	Voltage	Frame	Catalog Number	Full Eff. 100%	Full Amps 460V	Ship WT. (lbs.)
1	1800	208-230/460V	<b>143T</b>	HE14T02	82.5	1.49	47
	1200	208-230/460V	<b>145T</b>	HE16T02	80	1.7	47
1.5	3600	208-230/460V	<b>143T</b>	HE322T02	82.5	1.99	45
	1800	208-230/460V	<b>145T</b>	HE324T02	84	2.05	54
2	3600	208-230/460V	<b>145T</b>	HE22T02	84	2.6	47
	1800	208-230/460V	<b>145T</b>	HE24T02	84	2.7	56
	1200	208-230/460V	<b>184T</b>	HE26T01	86.5	3.2	88
3	3600	208-230/460V	<b>182T</b>	HE32T02	85.5	3.59	106
	1800	208-230/460V	<b>182T</b>	HE34T01	87.5	3.9	97
	1200	208-230/460V	<b>213T</b>	HE36T01	87.5	4.15	123
5	3600	208-230/460V	<b>184T</b>	HE52T01	87.5	5.9	114
	1800	208-230/460V	<b>184T</b>	HE54T01	87.5	6.48	102
	1200	208-230/460V	<b>215T</b>	HE56T01	87.5	6.8	175
7.5	3600	208-230/460V	<b>213T</b>	HE72T01	88.5	8.66	150
	1800	208-230/460V	<b>213T</b>	HE74T01	89.5	9.53	150
	1200	208-230/460V	<b>254T</b>	HE76T01	89.5	9.53	262
10	3600	208-230/460V	<b>215T</b>	HE102T01	89.5	11.7	150
	1800	208-230/460V	<b>215T</b>	HE104T01	89.5	12.8	165
	1200	208-230/460V	<b>256T</b>	HE106T01	89.5	13.4	304
15	3600	208-230/460V	<b>254T</b>	HE152T01	90.2	17	280
	1800	208-230/460V	<b>254T</b>	HE154T01	91	17.9	266
	1200	208-230/460V	<b>284T</b>	HE156T01	90.2	17.3	346
20	3600	208-230/460V	<b>256T</b>	HE202T01	90.2	23.3	313
	1800	208-230/460V	<b>256T</b>	HE204T01	91	24.4	313
	1200	208-230/460V	<b>286T</b>	HE206T01	90.2	23.5	470
25	3600	208-230/460V	<b>284TS</b>	HE252T01	91	29	353
	1800	208-230/460V	<b>284TS</b>	HE254T01	92.4	29.6	437
	1800	208-230/460V	<b>284T</b>	HE254T02	92.4	29.6	437
	1200	208-230/460V	<b>324T</b>	HE256T01	91.7	29.8	572

## EISA-Compliant High Efficient Cast Iron Motors Foot Mount TEFC

HP	RPM	Voltage	Frame	Catalog Number	Full Eff. 100%	Full Amps 460V	Ship WT. (lbs.)
30	3600	208-230/460V	<b>286TS</b>	HE302T01	91	33.8	404
	1800	208-230/460V	<b>286TS</b>	HE304T01	92.4	34.4	481
	1800	208-230/460V	<b>286T</b>	HE304T02	92.4	34.4	481
	1200	208-230/460V	<b>326T</b>	HE306T01	91.7	35.4	625
40	3600	208-230/460V	<b>324TS</b>	HE402T01	91.7	46.1	561
	1800	208-230/460V	<b>324TS</b>	HE404T01	93	47.6	587
	1800	208-230/460V	<b>324T</b>	HE404T02	93	47.6	587
	1200	208-230/460V	<b>364T</b>	HE406T01	93	47.1	992
50	3600	208-230/460V	<b>326TS</b>	HE502T01	92.4	56.5	594
	1800	208-230/460V	<b>326TS</b>	HE504T01	93	57.8	640
	1800	208-230/460V	<b>326T</b>	HE504T02	93	57.8	640
	1200	208-230/460V	<b>365T</b>	HE506T01	93	58.1	992
60	3600	208-230/460V	<b>364TS</b>	HE602T01	93	69	917
	1800	208-230/460V	<b>364TS</b>	HE604T01	93.6	67	963
	1800	208-230/460V	<b>364T</b>	HE604T02	93.6	67	963
	1200	208-230/460V	<b>404T</b>	HE606T01	93.6	70.1	1222
75	3600	208-230/460V	<b>365TS</b>	HE752T01	93	82.5	1025
	1800	208-230/460V	<b>365TS</b>	HE754T01	94.1	82.4	1010
	1800	208-230/460V	<b>365T</b>	HE754T02	94.1	82.4	1010
	1200	208-230/460V	<b>405T</b>	HE756T01	93.6	86.8	1291
100	3600	208-230/460V	<b>405TS</b>	HE1002T01	93.6	113	1361
	1800	208-230/460V	<b>405TS</b>	HE1004T01	94.5	115	1273
	1800	208-230/460V	<b>405T</b>	HE1004T02	94.5	115	1273
	1200	208-230/460V	<b>444T</b>	HE1006T01	94.1	121	1720
125	3600	460V	<b>444TS</b>	HE1252T01	94.5	131	1801
	1800	460V	<b>444TS</b>	HE1254T01	94.5	138	1647
	1800	460V	<b>444T</b>	HE1254T02	94.5	138	1647
	1200	460V	<b>445T</b>	HE1256T01	94.1	141	2050
150	3600	460V	<b>445TS</b>	HE1502T01	94.5	160	1865
	1800	460V	<b>445TS</b>	HE1504T01	95	168	1841
	1800	460V	<b>445T</b>	HE1504T02	95	168	1841
	1200	460V	<b>447T</b>	HE1506T01	95	171	2167
200	3600	460V	<b>447TS</b>	HE2002T01	95	223	2072
	1800	460V	<b>445T</b>	HE2004T01	95	230	2117
	1800	460V	<b>447T</b>	HE2004T02	95	230	2194
	1200	460V	<b>447T</b>	HE2006T01	95	236	2467

## EISA-Compliant High Efficient Cast Iron Motors Foot Mount TEFC

### Mounting and overall dimensions 143-449T

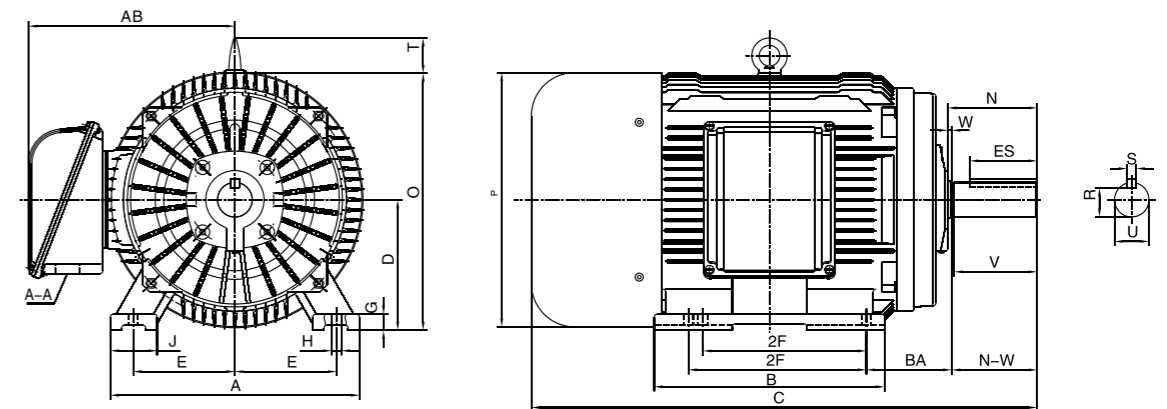

TYPE	A	B	C	D	E	2F	G	H	J	O	P	R	S	T	U	Vmin	ESmin	AA	AB	BA	N	N-W
143T/145T	7	6	14.3	3.5	2.75	4/5	0.52	0.34 Hole	1.58	7.52	6.89	0.771	0.188	1.42	0.875	2	1.41	3/4	6.36	2.25	2.44	2.25
182T/184T	9	7.3	17.3	4.5	3.75	4.5/5.5	0.67	0.41 Hole	1.97	9.83	8.66	0.986	0.25	1.73	1.125	2.5	1.78	3/4	7.66	2.75	2.99	2.75
213T/215T	10.5	9.4	21.2	5.25	4.25	5.5/7	0.73	0.41 Hole	2.2	11.62	10.87	1.201	0.312	2.05	1.375	3.12	2.41	1	8.65	3.5	3.65	3.38
254T/256T	12.3	12	26.5	6.25	5.0	8.25/10	0.79	0.53 Hole	2.44	13.8	12.33	1.416	0.375	2.05	1.625	3.75	2.91	1-1/4	11.26	4.25	4.4	4
284T/286T	13.8	13.6	28.8	7	5.5	9.5/11	0.87	0.53 Hole	2.84	15.6	14.22	1.591	0.5	2.44	1.875	4.38	3.28	1-1/2	12.98	4.75	5.02	4.62
284TS/286TS	13.8	13.6	27.1	7	5.5	9.5/11	0.87	0.53 Hole	2.84	15.6	14.22	1.416	0.375	2.44	1.625	3	1.91	1-1/2	12.98	4.75	5.02	3.25
324T/326T	15.3	14.1	31.5	8	6.25	10.5/12	1.03	0.66 Hole	2.95	17.32	15.67	1.845	0.5	2.44	2.125	5	3.91	2	14.55	5.25	5.25	5.25
324TS/326TS	15.3	14.1	30	8	6.25	10.5/12	1.03	0.66 Hole	2.95	17.32	15.67	1.591	0.5	2.44	1.875	3.5	2.03	2	14.55	5.25	5.65	3.75
364T/365T	17.2	16.2	34.5	9	7	11.25/12.25	1.1	0.66 Hole	3.23	18.98	17.6	2.021	0.625	2.44	2.375	5.62	4.28	3	15.56	5.88	6.28	5.88
364TS/365TS	17.2	16.2	32.02	9	7	11.25/12.25	1.1	0.66 Hole	3.23	18.98	17.6	1.591	0.5	2.44	1.875	3.5	2.03	3	15.56	5.88	6.28	3.75
404T/405T	19.22	20	37.6	10	8	12.25/13.75	1.2	0.81 Hole	3.35	20.96	19.15	2.45	0.75	2.84	2.875	7	5.65	3	17.37	6.62	7.28	7.25
404TS/405TS	19.22	20	34.6	10	8	12.25/13.75	1.2	0.81 Hole	3.35	20.96	19.15	1.845	0.5	2.84	2.125	4	2.78	3	17.37	6.62	7.73	4.25
444T/445T	21.76	21.26	42.5	11	9	14.5/16.5	1.2	0.81 Hole	3.74	23.5	21.57	2.88	0.875	4.1	3.375	8.25	6.91	3	19.87	7.5	8.98	8.5
444TS/445TS	21.76	21.26	38.75	11	9	14.5/16.5	1.2	0.81 Hole	3.74	23.5	21.57	2.021	0.625	4.1	2.375	4.5	3.03	3	19.87	7.5	8.98	4.75
447T/449T	21.76	28.74	53.55	11	9	20/25	1.2	0.81 Hole	3.74	23.5	23.35	2.88	0.875	4.1	3.375	8.25	6.91	3	20.87	7.5	8.98	8.5
447TS/449TS	21.76	28.74	49.8	11	9	20/25	1.2	0.81 Hole	3.74	23.5	23.35	2.021	0.625	4.1	2.375	4.5	3.03	3	20.87	7.5	8.98	4.75

## EISA-Compliant High Efficient Cast Iron Motors

### C Face Mount TEFC

### Mounting and overall dimensions

# 143-449TC

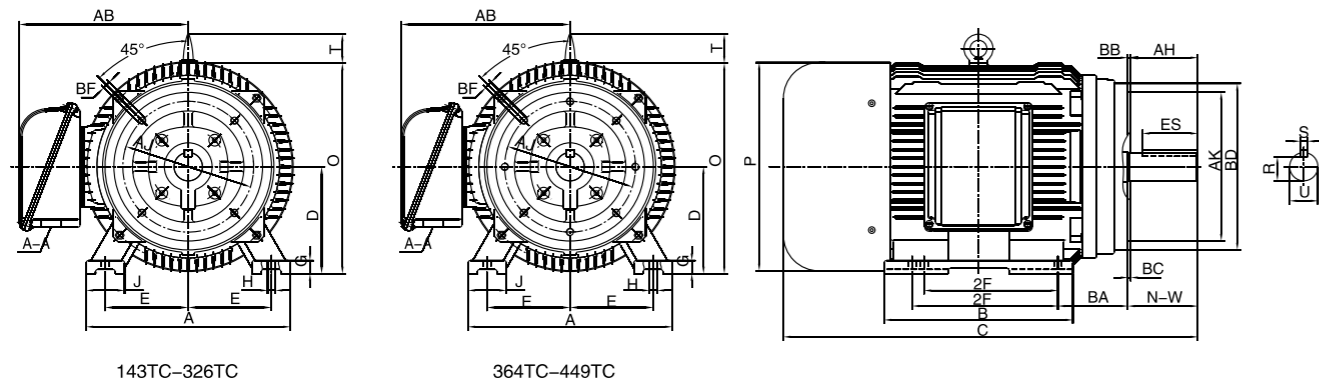

TYPE	A	B	C	D	E	2F	G	H	J	O	P	R	S	T	U	Vmin	ESmin	AA	AB	BA	N	N-W	AH	AJ	AK	BB	BC	BD	BF hole
143TC/145TC	7	6	14.2	3.5	2.75	4/5	0.52	0.34Hole	1.58	7.52	6.89	0.771	0.188	1.42	0.875	2	1.41	3/4	6.36	2.75	2.44	2.25	2.12	5.875	4.5	0.16	+0.12	6.5	3/8-16
182TC/184TC	9	7.3	17.3	4.5	3.75	4.5/5.5	0.67	0.41Hole	1.97	9.83	8.66	0.986	0.25	1.73	1.125	2.5	1.78	3/4	7.66	3.5	2.99	2.75	2.62	7.25	8.5	0.25	+0.12	9	1/2-13
213TC/215TC	10.5	9.4	20.8	5.25	4.25	5.5/7	0.73	0.41Hole	2.2	11.62	10.87	1.201	0.312	2.05	1.375	3.12	2.41	1	8.65	4.25	3.65	3.38	3.12	7.25	8.5	0.25	+0.25	9	1/2-13
254TC/256TC	12.3	12	26.4	6.25	5.0	8.25/10	0.79	0.53Hole	2.44	13.8	12.33	1.416	0.375	2.05	1.625	3.75	2.91	1-1/4	11.26	4.75	4.4	4	3.75	7.25	8.5	0.25	+0.25	10	1/2-13
284TC/286TC	13.8	13.6	28.8	7	5.5	9.5/11	0.87	0.53Hole	2.84	15.6	14.22	1.591	0.5	2.44	1.875	4.38	3.28	1-1/2	12.98	4.75	5.02	4.62	4.38	9	10.5	0.25	+0.25	11.25	1/2-13
284TSC/286TSC	13.8	13.6	27.1	7	5.5	9.5/11	0.87	0.53Hole	2.84	15.6	14.22	1.416	0.375	2.44	1.625	3	1.91	1-1/2	12.98	4.75	5.02	3.25	3.0	9	10.5	0.25	+0.25	11.25	1/2-13
324TC/326TC	15.3	14.1	31.5	8	6.25	10.5/12	1.03	0.66Hole	2.95	17.32	15.67	1.845	0.5	2.44	2.125	5	3.91	2	14.55	5.25	5.25	5.25	5.0	11	12.5	0.25	+0.25	14	5/8-11
324TSC/326TSC	15.3	14.1	30	8	6.25	10.5/12	1.03	0.66Hole	2.95	17.32	15.67	1.591	0.5	2.44	1.875	3.5	2.03	2	14.55	5.25	5.65	3.75	3.5	11	12.5	0.25	+0.25	14	5/8-11
364TC/365TC	17.2	16.2	34.5	9	7	11.25/12.25	1.1	0.66Hole	3.23	18.98	17.6	2.021	0.625	2.44	2.375	5.62	4.28	3	15.56	5.88	6.28	5.88	5.62	11	12.5	0.25	+0.25	14	5/8-11
364TSC/365TSC	17.2	16.2	32.02	9	7	11.25/12.25	1.1	0.66Hole	3.23	18.98	17.6	1.591	0.5	2.44	1.875	3.5	2.03	3	15.56	5.88	6.28	3.75	3.5	11	12.5	0.25	+0.25	14	5/8-11
404TC/405TC	19.22	20	37.6	10	8	12.25/13.75	1.2	0.81Hole	3.35	20.96	19.15	2.45	0.75	2.84	2.875	7	5.65	3	17.37	6.62	7.28	7.25	7.0	11	12.5	0.25	+0.25	15.5	5/8-11
404TSC/405TSC	19.22	20	34.6	10	8	12.25/13.75	1.2	0.81Hole	3.35	20.96	19.15	1.845	0.5	2.84	2.215	4	2.78	3	17.37	6.62	7.73	4.25	4.0	11	12.5	0.25	+0.25	15.5	5/8-11
444TC/445TC	21.76	21.26	42.5	11	9	14.5/16.5	1.2	0.81Hole	3.74	23.5	21.57	2.88	0.875	4.1	3.375	8.25	6.91	3	19.87	7.5	8.98	8.5	8.25	14	16	0.25	+0.25	18	5/8-11
444TSC/445TSC	21.76	21.26	38.75	11	9	14.5/16.5	1.2	0.81Hole	3.74	23.5	21.57	2.021	0.625	4.1	2.375	4.5	3.03	3	19.87	7.5	8.98	4.75	4.5	14	16	0.25	+0.25	18	5/8-11
447TC/449TC	21.76	28.74	53.55	11	9	20/25	1.2	0.81Hole	3.74	23.5	23.35	2.88	0.875	4.1	3.375	8.25	6.91	3	20.87	7.5	8.98	8.5	8.25	14	16	0.25	+0.25	18	5/8-11
447TSC/449TSC	21.76	28.74	49.8	11	9	20/25	1.2	0.81Hole	3.74	23.5	23.35	2.021	0.625	4.1	2.375	4.5	3.03	3	20.87	7.5	8.98	4.75	4.5	14	16	0.25	+0.25	18	5/8-11

## Three Phase Roll Steel Motors

### Foot Mount TEFC

### Applications:

Designed for pumps, fans, compressors, material handling and other general purpose applications in damp dusty or dirty environment.

### Features:

Class F Insulation  
 Rolled Steel Frame  
 Aluminum End Shields  
 Design B

Double Shielded Bearings  
 40°C Ambient  
 High Efficient



HP	RPM	Voltage	Frame	Catalog Number	SF	Full load Eff.	Full load Amps	Ship WT. (lbs.)
1/4	3600	230/460	48	RT142T01	1	68.0	1.11/0.55	17
	1800	230/460	48	RT144T01	1	60.2	1.25/0.63	19
1/3	3600	230/460	48	RT132T01	1	72.0	1.15/0.57	21
	3600	230/460	56	RT132T02	1	72.0	1.16/0.58	23
	1800	230/460	48	RT134T01	1	67.0	1.32/0.66	23
	1800	230/460	56	RT134T02	1	67.0	1.38/0.69	22
1/2	3600	230/460	48	RT122T01	1	74.0	1.57/0.78	23
	3600	230/460	56	RT122T02	1	74.0	1.65/0.83	26
	1800	230/460	48	RT124T01	1	70.0	1.7/0.85	26
	1800	230/460	56	RT124T02	1	70.0	1.84/0.92	23
3/4	3600	230/460	56	RT342T01	1	76.0	2.34/1.17	30
	1800	230/460	56	RT344T01	1	74.0	2.57/1.28	25
1	3600	230/460	143T	RT12T01	1.25	77.0	3.13/1.57	39
	1800	230/460	56	RT14T01	1.25	85.5	2.98/1.49	42
1 1/2	3600	230/460	143T	RT322T01	1.25	84.0	3.96/1.98	51
	1800	230/460	143T	RT324T01	1.25	86.5	4.20/2.10	50
2	3600	230/460	145T	RT22T01	1.25	85.5	5.31/2.65	55
	1800	230/460	56	RT24T01	1.25	86.5	5.65/2.83	52
	1800	230/460	145T	RT24T02	1.25	86.5	5.51/2.76	53
3	3600	230/460	145T	RT32T01	1.25	86.5	7.17/3.59	83
	1800	230/460	182T	RT34T01	1.25	89.5	7.81/3.91	76
5	3600	230/460	184T	RT52T01	1.25	88.5	11.5/5.77	98
	1800	230/460	184T	RT54T01	1.25	89.5	13.1/6.57	92
7 1/2	3600	230/460	184T	RT72T01	1.25	89.5	17.5/8.76	87
	1800	230/460	213T	RT74T01	1.25	91.7	18.1/9.17	128
10	3600	230/460	215T	RT102T01	1.25	90.2	23.7/11.9	123
	1800	230/460	215T	RT104T01	1.25	91.7	24.7/12.4	136



## Three Phase Roll Steel Motors Foot Mount ODP

### Applications:

Designed for pumps, fans, compressors, material handling and other general purpose applications where contaminants are minimal.

### Features:

Class F Insulation  
Rolled Steel Frame  
Aluminum End Shields  
Design B

Double Shielded Bearings  
40°C Ambient  
High Efficient



HP	RPM	Voltage	Frame	Catalog Number	SF	Full load Eff.	Full load Amps	Ship WT. (lbs.)
1/4	3600	230/460	48	RT142D01	1.35	68.1	1.11/0.55	17
	1800	230/460	48	RT144D01	1.35	60.2	1.25/0.63	19
1/3	3600	230/460	48	RT132D01	1.35	72.0	1.15/0.57	21
	3600	230/460	56	RT132D02	1.35	72.0	1.16/0.58	23
	1800	230/460	48	RT134D01	1.35	67.0	1.32/0.66	23
1/2	1800	230/460	56	RT134D02	1.35	67.0	1.38/0.69	22
	3600	230/460	48	RT142D01	1.25	74.0	1.53/0.76	23
	3600	230/460	56	RT142D02	1.25	74.0	1.61/0.83	26
3/4	1800	230/460	48	RT144D01	1.25	70.0	1.7/0.85	26
	1800	230/460	56	RT144D02	1.25	70.0	1.84/0.92	23
	3600	230/460	48	RT342D01	1.25	76.0	2.34/1.17	30
1	1800	230/460	56	RT344D01	1.25	74.0	2.57/1.28	25
	3600	230/460	143T	RT12D01	1.15	77.0	3.13/1.57	39
1 1/2	1800	230/460	56H	RT14D01	1.15	85.5	2.89/1.49	42
	3600	230/460	143T	RT322D01	1.15	84.0	3.96/1.98	52
2	1800	230/460	56H	RT324D01	1.15	86.5	4.2/2.1	50
	3600	230/460	145T	RT222D01	1.15	85.5	5.31/2.65	54
	1800	230/460	145T	RT224D01	1.15	86.5	5.65/2.83	52
3	1800	230/460	56HZ	RT224D02	1.15	86.5	5.51/2.76	53
	3600	230/460	182T	RT32D01	1.15	85.5	7.26/3.63	82
5	1800	230/460	182T	RT34D01	1.15	89.5	7.81/3.91	76
	3600	230/460	182T	RT52D01	1.15	86.5	11.8/5.9	98
7 1/2	1800	230/460	184T	RT54D01	1.15	89.5	13.1/6.57	92
	3600	230/460	184T	RT72D01	1.15	88.5	17.7/8.86	88
10	1800	230/460	213T	RT74D01	1.15	91.0	18.3/9.14	127
	3600	230/460	213T	RT102D01	1.15	89.5	23.9/12	122
10	1800	230/460	215T	RT104D01	1.15	91.7	24.7/12.4	136

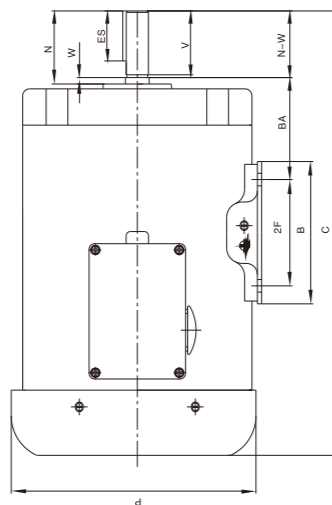
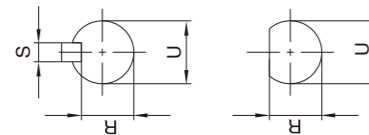
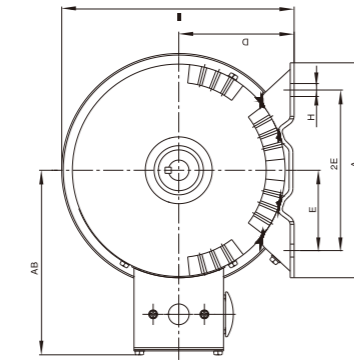

Frame size	AB	BA	MAX A	MAX B	C	D	E	2F	H	N	N-W	O	P	R	S	U	MIN V	MIN ES	MIN AA
48	5.3	2.5	6	3.8	10	3	2.2	2.75	0.34	1.62	1.5	5.83	5.66	0.453		0.5	1.25		1/2
56	5.6	2.75	6.5	4.2	12.7	3.5	2.44	3	0.34	2.4	1.88	6.7	7.08	0.517	0.188	0.625	1.5	1.41	1/2
143T	5.6	2.25	7	6.18	14.6	3.5	2.75	4	0.34	2.46	2.25	6.7	7.08	0.771	0.188	0.875	2	1.41	3/4
145T	5.6	2.25	7	6.18	14.6	3.5	2.75	5	0.34	2.46	2.25	6.7	7.08	0.771	0.188	0.875	2	1.41	3/4
182T	7.2	2.75	8.5	6.5	18.8	4.5	3.75	4.5	0.41	2.98	2.75	9.25	9.65	0.986	0.25	1.125	2.5	1.78	3/4
184T	7.2	2.75	8.5	6.5	18.8	4.5	3.75	5.5	0.41	2.98	2.75	9.25	9.65	0.986	0.25	1.125	2.5	1.78	3/4
213T	7.5	3.5	9.5	8	20.5	5.25	4.25	5.5	0.41	3.66	3.38	9.84	10	1.201	0.312	1.375	3.12	2.41	1
215T	7.5	3.5	9.5	8	20.5	5.25	4.25	7.0	0.41	3.66	3.38	9.84	10	1.201	0.312	1.375	3.12	2.41	1

## Three Phase Roll Steel Motors Foot Mount TEFC

### Mounting and overall dimensions TEFC 48-215T

## Three Phase Roll Steel Motors Foot Mount ODP

### Mounting and overall dimensions ODP 48-215T

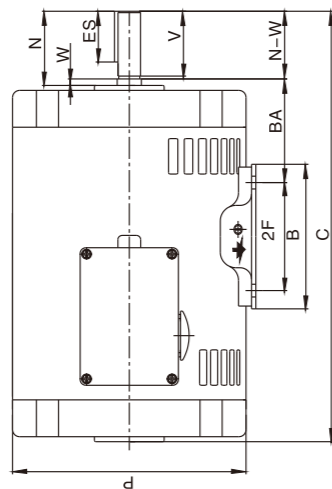
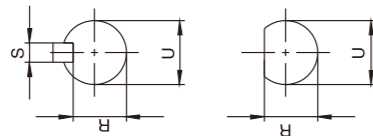
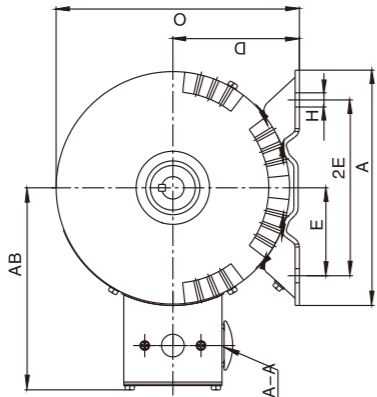

# NEMA

## Full Line Motors

Frame size	AB	BA	MAX A	MAX B	C	D	E	2F	H	N	N-W	O	P	R	S	U	MIN V	MIN ES	MIN AA
48	5.3	2.5	6	3.8	10	3	2.2	2.75	0.34	1.62	1.5	5.83	5.66	0.453		0.5	1.125		1/2
56	5.6	2.75	6.5	4.2	11.4	3.5	2.44	3	0.34	2.4	1.88	6.7	6.45	0.517	0.188	0.625	1.5	1.41	1/2
143T	5.6	2.25	7	6.18	13.3	3.5	2.75	4	0.34	2.46	2.25	6.7	6.45	0.771	0.188	0.875	2	1.41	3/4
145T	5.6	2.25	7	6.18	13.3	3.5	2.75	5	0.34	2.46	2.25	6.7	6.45	0.771	0.188	0.875	2	1.41	3/4
182T	7.2	2.75	8.5	6.5	16.5	4.5	3.75	4.5	0.41	2.98	2.75	9.25	8.5	0.986	0.25	1.125	2.5	1.78	3/4
184T	7.2	2.75	8.5	6.5	16.5	4.5	3.75	5.5	0.41	2.98	2.75	9.25	8.5	0.986	0.25	1.125	2.5	1.78	3/4
213T	7.5	3.5	9.5	8	18	5.25	4.25	5.5	0.41	3.66	3.38	9.84	9	1.201	0.312	1.375	3.12	2.41	1
215T	7.5	3.5	9.5	8	18	5.25	4.25	7.0	0.41	3.66	3.38	9.84	9	1.201	0.312	1.375	3.12	2.41	1

## EISA-Compliant High Efficient Aluminum Motors Foot Mount TEFC

### Applications:

General purpose use on pumps, fans, blowers, compressors, conveyors, reducers and other industrial machinery .

### Features:

Service Factor 1.15  
EISA-Compliant High efficient  
Class F insulation  
TEFC enclosure  
Removable Base

Aluminum frame, end shield  
Maximum 40°C ambient temperature  
Design C high torque  
D Flange Available  
Low noise



HP	RPM	Voltage	Frame	Catalog Number	Full Eff. 100%	Full Amps	Ship WT. (lbs.)
1/4	3260	208-230/460	48	AE142T01	65	0.96-0.9/0.43	17
	1570	208-230/460	48	AE144T01	60	1.14-1/0.52	18
	1020	208-230/460	56	AE146T01	56	1.35-1.2/0.61	23
1/3	3260	208-230/460	48	AE132T01	68	1.26-1.1/0.57	18
	1595	208-230/460	48	AE134T01	65	1.44-1.3/0.65	19
1/2	3285	208-230/460	48	AE122T01	70	1.81-1.6/0.82	19
	1595	208-230/460	56	AE124T01	67	2.04-1.8/0.92	26
	1060	208-230/460	56	AE126T01	62	2.37-2.1/1.07	24
3/4	3285	208-230/460	48	AE342T01	73	2.55-2.3/1.15	20
	1665	208-230/460	56	AE344T01	71.1	2.86-2.6/1.29	28
	1060	208-230/460	143T	AE346T01	65	3.26-3/1.48	27
1	3405	208-230/460	56	AE12T01	75.1	3.34-3/1.51	26
	1665	208-230/460	143T	AE14T01	73.1	3.75-3.4/1.69	29
	1090	208-230/460	145T	AE16T01	69	4.19-3.8/1.89	29
	815	208-230/460	182T	AE18T01	71	4.38-4/1.98	57
1 1/2	3405	208-230/460	143T	AE322T01	77	4.72-4.3/2.13	28
	1665	208-230/460	145T	AE324T01	76.3	5.2-4.7/2.35	30
	1090	208-230/460	182T	AE326T01	72.1	5.8-5.2/2.62	57
	815	208-230/460	184T	AE328T01	73	6.06-5.5/2.74	62
2	3405	208-230/460	145T	AE22T01	79	6.27-5.7/2.84	30
	1665	208-230/460	145T	AE24T01	78.6	6.71-6.1/3.03	31
	1100	208-230/460	184T	AE26T01	76.1	7.29-6.6/3.3	64
	825	208-230/460	213T	AE28T01	75	8.05-7.3/3.64	84
3	3405	208-230/460	145T	AE32T01	81.1	8.86-8/4.01	33
	1690	208-230/460	182T	AE34T01	81.2	9.28-8.4/4.2	62
	1150	208-230/460	213T	AE36T01	81.1	9.91-9/4.48	84
5	845	208-230/460	215T	AE38T01	78	11-10/4.99	93
	3455	208-230/460	184T	AE52T01	84.4	13.8-13/6.25	62
	1720	208-230/460	184T	AE54T01	84.3	14.9-13/6.72	66
7 1/2	1150	208-230/460	215T	AE56T01	82.1	16.5-15/7.44	97
	860	208-230/460	254T	AE58T01	81	17.4-16/7.85	152
	3480	208-230/460	184T	AE72T01	85.9	20.2-18/9.13	86
10	1725	208-230/460	213T	AE74T01	85.8	21.4-19/9.69	93
	1150	208-230/460	254T	AE76T01	84.1	23.6-21/10.7	150
	860	208-230/460	256T	AE78T01	83	24.9-22/11.2	192
15	3480	208-230/460	215T	AE102T01	87.2	27.1-25/12.3	110
	1725	208-230/460	215T	AE104T01	87.1	28.5-26/12.9	107
	1150	208-230/460	256T	AE106T01	86.1	31.4-28/14.2	161
20	3515	208-230/460	254T	AE152T01	88.5	38.8-35/17.5	150
	1750	208-230/460	254T	AE154T01	88.5	41.1-37/18.6	163
25	3515	208-230/460	256T	AE202T01	89.5	52.3-47/23.6	181
	1750	208-230/460	256T	AE204T01	89.5	54.7-49/24.7	191
	3515	208-230/460	284T	AE252T01	90.2	63.3-57/28.6	225
30	1760	208-230/460	284T	AE254T01	90.1	66.3-60/30	223
	3525	208-230/460	286T	AE302T01	90.7	74.8-68/33.8	265
	1760	208-230/460	286T	AE304T01	90.6	78.4-71/35.4	247

# EISA-Compliant High Efficient Aluminum Motors Foot Mount TEFC

## Mounting and overall dimensions 143T-286T

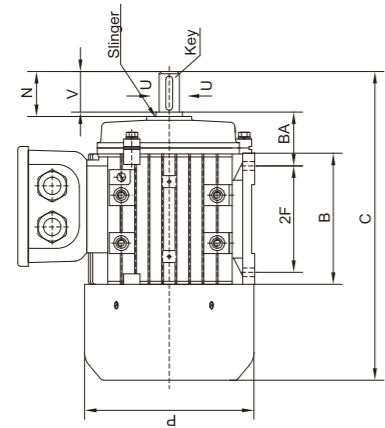
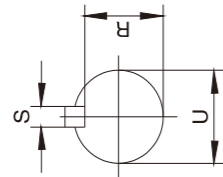
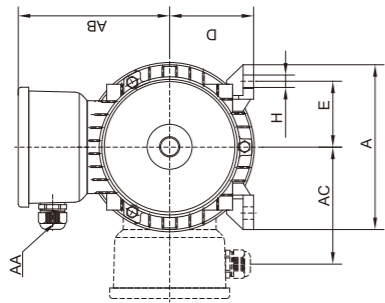

NEMA Frame	Key	C	O	P	S	R	U	N-W	AA	AB	AC	AH	AJ	AK	BB	BC	BD	Tap B F
48C	1.41	10.5	5.85	5.4	0.188	0.453	0.5	1.5	0.5	4.65	3.5	1.69	3.75	3	0.16	-0.19	5.625	1/4-20
56C	1.41	13.8	7.34	7.5	0.188	0.517	0.625	1.88	0.5	5.5	4.5	2.06	5.875	4.5	0.16	-0.19	6.5	3/8-16
143TC	1.41	13.2																
145TC	1.41	14.1	7.48	7.5	0.188	0.771	0.875	2.12	0.75	6.38	5	2.25	5.875	4.5	0.16	0.12	6.51	3/8-16
182TC	1.78	18	9.23	8.7	0.25	0.986	1.125	2.62	0.75	7.12	5.75	2.75	7.25	8.5	0.25	0.12	9	1/2-13
184TC	2.41	19	10.99	10.2	0.312	1.201	1.375	3.38	1	9.22	7.43	3.15	7.25	8.5	0.25	0.25	9	1/2-13
213TC	2.91	20.4																
215TC	2.91	23.6	12.96	12.4	0.375	1.418	1.625	4	1.25	10.48	8.66	3.75	7.25	8.5	0.25	0.25	10	1/2-13
254TC	3.28	29	14.74	14	0.5	1.591	1.875	4.63	1.5	12.46	10.14	4.38	9	10.5	0.25	0.25	11.25	1/2-13
256TC		30.5																
284TC																		
286TC																		

# NEMA Full Line Motors

## Single Phase Roll Steel Motors C Face TEFC

### Applications:

Designed for pumps, fans, compressors, material handling and other general purpose applications in damp dusty or dirty environment.

### Features:

- Class F Insulation
- Rolled Steel Frame
- Aluminum End Shields
- Design B
- Double Shielded Bearings
- 40 °C Ambient
- High Efficient



HP	RPM	Voltage	Frame	Catalog Number		SF	Full load Eff.	Full load Amps	Ship WT. (lbs.)
				Footed	Footless				
1/4	3600	115/230	48C	RS142T11	RS142T21	1	61	3.4/1.7	17
	1800	115/230	48C	RS144T11	RS144T21	1	65	4.2/2.1	19
1/3	3600	115/230	48C	RS132T11	RS132T21	1.15	65	4.2/2.1	21
	3600	115/230	56C	RS132T12	RS132T22	1.35	58	5.2/2.6	23
	1800	115/230	48C	RS134T11	RS134T21	1.15	68	5.2/2.6	23
1/2	1800	115/230	56C	RS134T12	RS134T22	1	65	4.8/2.4	22
	3600	115/230	48C	RS122T11	RS122T21	1.15	69	5.8/2.9	23
	3600	115/230	56C	RS122T12	RS122T22	1.15	65	6.6/3.3	26
3/4	1800	115/230	48C	RS124T11	RS124T21	1.15	71	7.2/3.6	26
	1800	115/230	56C	RS124T12	RS124T22	1.25	69	6.4/3.2	23
	3600	115/230	56C	RS342T11	RS342T21	1.15	70	8.6/4.3	30
1	1800	115/230	56C	RS344T11	RS344T21	1	73	8.8/4.4	25
	3600	115/230	56C	RS12T11	RS12T21	1.15	73	10.8/5.4	36
1 1/2	1800	115/230	56C	RS14T11	RS14T21	1.15	75	11.2/5.6	40
	3600	115/230	143TC	RS322T11	RS322T21	1.15	74	13.8/6.9	45
2	1800	115/230	145TC	RS344T11	RS344T21	1	76	13.4/6.7	48
	3600	115/230	56C	RS22T11	RS22T21	1.15	76	18.0/9.0	40
	3600	230	145TC	RS22T12	RS22T22	1.15	76	9	51
3	1800	115/230	145TC	RS24T11	RS24T21	1.15	77	17.8/8.9	75
	3600	230	182TC	RS32T11	RS32T21	1	78	13.1	81
5	1800	230	182TC	RS34T11	RS34T21	1	79	13	75
	3600	230	184TC	RS52T11	RS52T21	1	80	21.3	97
	1800	230	184TC	RS54T11	RS54T21	1	82	20.8	90

# Single Phase Roll Steel Motors

## C Face TEFC

### Mounting and overall dimensions TEFC 48C-215TC

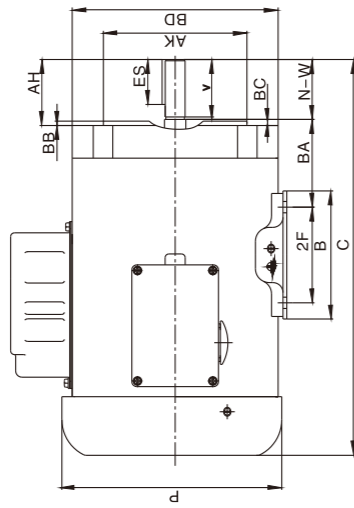
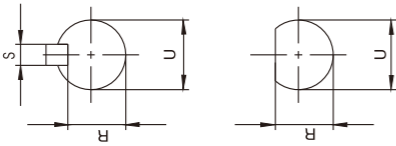
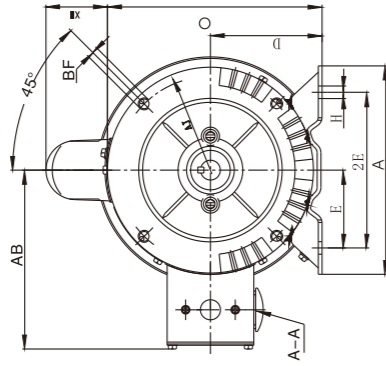

# NEMA

## Full Line Motors

Frame size	AB	BA	MAX A	MAX B	C	D	E	2F	N-W	O	P	R	S	U	MIN ES	MIN AA	B F	MAX BB	MAX BD	BC	AH	AJ	AK
48C	5.3	2.5	6	3.8	10	3.0	2.12	2.75	1.5	5.83	5.66	0.453		0.5		1/2	1/4-20	5.625	-0.19	1.69	3.75	3	
56C	5.6	2.75	6.5	4.2	12.7	3.5	2.44	3	1.88	6.7	7.08	0.517	0.188	0.625	1.41	1/2	3/8-16	6.5	-0.19	2.06	5.875	4.5	
143TC								4								3/4	1/2-13	6.5	+0.12	2.12	5.875	4.5	
145TC	5.6	2.75	7	6.18	14.6	3.5	2.75	5	2.25	6.7	7.08	0.771	0.188	0.875	1.41								
182TC								4.5															
184TC	7.2	3.5	8.5	6.5	18.8	4.5	3.75	5.5	2.75	9.25	9.65	0.986	0.25	1.125	1.78	3/4	1/2-13	9	+0.12	2.62	7.25	8.5	
213TC								5.5															
215TC	7.5	4.25	9.5	8	20.5	5.25	4.25	7.0	3.38	9.84	10	1.201	0.312	1.375	2.41	1	1/2-13	9	+0.25	3.12	7.25	8.5	

# Single Phase Roll Steel Motors

## C Face ODP

### Applications:

Designed for pumps, fans, compressors, material handling and other general purpose applications where contaminants are minimal.

### Features:

- Class F Insulation
- Double Shielded Bearings
- Rolled Steel Frame
- 40 °C Ambient
- Aluminum End Shields
- High Efficient
- Design B



HP	RPM	Voltage	Frame	Catalog Number		SF	Full load Eff.	Full load Amps	Ship WT. (lbs.)
				Footed	Footless				
1/4	3600	115/230	48C	RS142D11	RS142D21	1.35	58	3.8/1.9	17
	1800	115/230	48C	RS144D11	RS144D21	1.35	61	4.6/2.3	19
1/3	3600	115/230	48C	RS132D11	RS132D21	1.35	62	4.8/2.4	21
	3600	115/230	56C	RS132D12	RS132D22	1.35	58	5.2/2.6	23
	1800	115/230	48C	RS134D11	RS134D21	1.35	65	5.4/2.7	23
1/2	1800	115/230	56C	RS134D12	RS134D22	1.35	65	4.8/2.4	22
	3600	115/230	48C	RS122D11	RS122D21	1.25	68	6.2/3.1	23
	3600	115/230	56C	RS122D12	RS122D22	1.25	65	6.6/3.3	26
	1800	115/230	48C	RS124D11	RS124D21	1.25	69	7.6/3.8	26
3/4	1800	115/230	56C	RS124D12	RS124D22	1.25	69	6.4/3.2	23
	3600	115/230	56C	RS342D11	RS342D21	1.25	70	8.6/4.3	30
1	1800	115/230	56C	RS344D11	RS344D21	1.25	73	8.8/4.4	25
	3600	115/230	56C	RS12D11	RS12D21	1.25	73	10.8/5.4	36
1 1/2	1800	115/230	56C	RS14D11	RS14D21	1.15	75	11.2/5.6	40
	3600	115/230	143TC	RS322D11	RS322D21	1.15	74	13.8/6.9	45
2	1800	115/230	145TC	RS344D11	RS344D21	1.15	76	13.4/6.7	48
	3600	115/230	145TC	RS22D11	RS22D21	1.15	76	18.0/9.0	40
	1800	115/230	145TC	RS24D11	RS24D21	1.15	77	17.8/8.9	75
3	3600	230	182TC	RS32D11	RS32D21	1.15	78	13.1	81
	1800	230	182TC	RS34D11	RS34D21	1.15	79	13	78
5	3600	230	184TC	RS52D11	RS52D21	1.15	80	21.3	97
	1800	230	184TC	RS54D11	RS54D21	1.15	82	20.8	90

# NEMA Full Line Motors

## Single Phase Roll Steel Motors C Face ODP

### Mounting and overall dimensions ODP 48C-215TC

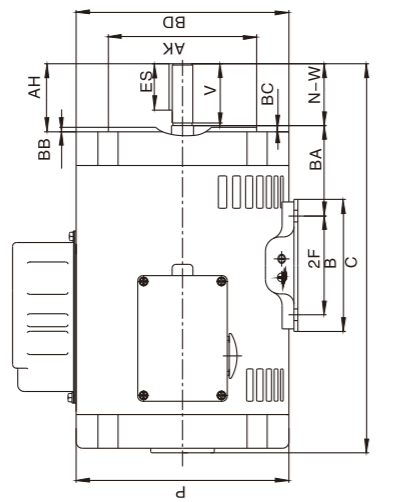
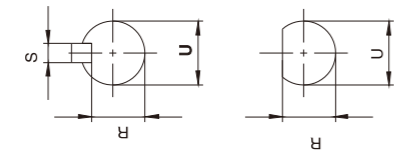
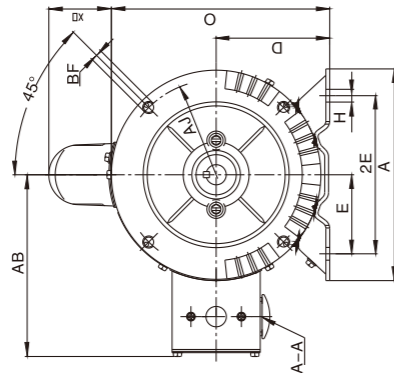

Frame size	AB	BA	MAX A	MAX B	C	D	E	2F	N-W	O	P	R	S	U	MIN ES	MIN AA	BF	MAX BB	MAX BD	BC	AH	AJ	AK
	48C	5.3	2.5	6	3.8	10	3.0	2.12	2.75	1.5	5.83	5.66	0.453		0.5	1/2	1/4-20	0.16	5.625	-0.19	1.69	3.75	3
56C	5.6	2.75	6.5	4.2	11.4	3.5	2.44	3	1.88	6.7	6.45	0.517		0.625	1/2	3/8-16	0.16	6.5	-0.19	2.06	5.875	4.5	
143TC								4															
145TC	5.6	2.75	7	6.18	13.3	3.5	2.75	5	2.25	6.7	6.45	0.771		0.875	3/4	1/2-13	0.16	6.5	+0.12	2.12	5.875	4.5	
182TC								4.5															
184TC	7.2	3.5	8.5	6.5	16.5	4.5	3.75	5.5	2.75	9.25	8.5	0.986		1.125	3/4	1/2-13	0.25	9	+0.12	2.62	7.25	8.5	
213TC								5.5															
215TC	7.5	4.25	9.5	8	18	5.25	4.25	7.0	3.38	9.84	9	1.201		1.375	1	1/2-13	0.25	9	+0.25	3.12	7.25	8.5	

## Premium Efficient Cast Iron Motors C Face TEFC

### Applications:

General purpose use on pumps, fans, blowers, compressors, conveyors, and other industrial machinery installed in damp, dusty. Or dirty environments. Additionally, cast iron frame motors may be suitable for the process industries.

### Features:

Service Factor 1.15  
Premium efficient  
Class F insulation

Cast Iron frame, end shield  
Maximum 40°C ambient temperature  
Design B



HP	RPM	Voltage	Frame	Catalog Number		Full load Eff.	Full Amps 460V	Ship WT. (lbs.)
				Footed	Footless			
1	1800	208-230/460V	143TC	PE14T11	PE14T21	85.5	1.43	54
	1200	208-230/460V	145TC	PE16T11	PE16T21	82.5	1.73	56
1.5	3600	208-230/460V	143TC	PE322T11	PE322T21	84	1.98	45
	1800	208-230/460V	145TC	PE324T11	PE324T21	86.5	2	56
2	1200	208-230/460V	182TC	PE326T11	PE326T21	87.5	2.39	79
	3600	208-230/460V	145TC	PE22T11	PE22T21	85.5	2.65	52
2	1800	208-230/460V	145TC	PE24T11	PE24T21	86.5	2.63	58
	1200	208-230/460V	184TC	PE26T11	PE26T21	88.5	3.23	97
3	3600	208-230/460V	182TC	PE32T11	PE32T21	86.5	3.68	99
	1800	208-230/460V	182TC	PE34T11	PE34T21	89.5	3.9	99
5	3600	208-230/460V	184TC	PE52T11	PE52T21	88.5	5.76	114
	1800	208-230/460V	184TC	PE54T11	PE54T21	89.5	6.4	108
	1200	208-230/460V	215TC	PE56T11	PE56T21	89.5	6.83	175
7.5	3600	208-230/460V	213TC	PE72T11	PE72T21	89.5	8.63	134
	1800	208-230/460V	213TC	PE74T11	PE74T21	91.7	9.29	165
	1200	208-230/460V	254TC	PE76T11	PE76T21	91	9.73	282
10	3600	208-230/460V	215TC	PE102T11	PE102T21	90.2	11.5	173
	1800	208-230/460V	215TC	PE104T11	PE104T21	91.7	12.6	172
	1200	208-230/460V	256TC	PE106T11	PE106T21	91	13.3	316
15	3600	208-230/460V	254TC	PE152T11	PE152T21	91	16.9	280
	1800	208-230/460V	254TC	PE154T11	PE154T21	92.4	18	291
	1200	208-230/460V	284TC	PE156T11	PE156T21	91.7	17.3	360
20	3600	208-230/460V	256TC	PE202T11	PE202T21	91	22.9	313
	1800	208-230/460V	256TC	PE204T11	PE204T21	93	24.4	324
	1200	208-230/460V	286TC	PE206T11	PE206T21	91.7	24.1	503
25	3600	208-230/460V	284TSC	PE252T11	PE252T21	91.7	28.4	353
	1800	208-230/460V	284TC	PE254T11	PE254T21	93.6	29.5	481
30	3600	208-230/460V	286TSC	PE302T11	PE302T21	91.7	33.4	428
	1800	208-230/460V	286TC	PE304T11	PE304T21	93.6	35.1	525
40	3600	208-230/460V	324TSC	PE402T11	-	92.4	45.8	561
	1800	208-230/460V	324TC	PE404T11	-	94.1	48.3	640
50	3600	208-230/460V	326TSC	PE502T11	-	93	55.5	607
	1800	208-230/460V	326TC	PE504T11	-	94.5	60.6	662
60	3600	208-230/460V	364TSC	PE602T11	-	93.6	68.3	992
	1800	208-230/460V	364TC	PE604T11	-	95	68.4	1036
75	3600	208-230/460V	365TSC	PE752T11	-	95	82.6	1025
	1800	208-230/460V	365TC	PE754T11	-	95.4	82.3	1047
100	3600	208-230/460V	405TSC	PE1002T11	-	94.1	111	1361
	1800	208-230/460V	405TC	PE1004T11	-	95.4	112	1302
125	3600	208-230/460V	444TSC	PE1252T11	-	95	133	1794
	1800	208-230/460V	444TC	PE1254T11	-	95.4	138	1841
150	3600	460V	445TSC	PE1502T11	-	95	161	1865
	1800	460V	445TC	PE1504T11	-	95.8	170	1940
200	3600	460V	447TSC	PE2002T11	-	95.4	221	2072
	1800	460V	447TC	PE2004T11	-	96.2	230	2216



# Premium Efficient Cast Iron Motors

C Face ODP

Mounting and overall dimensions **254TC-445TC**

# NEMA Full Line Motors

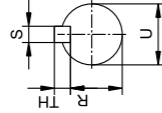
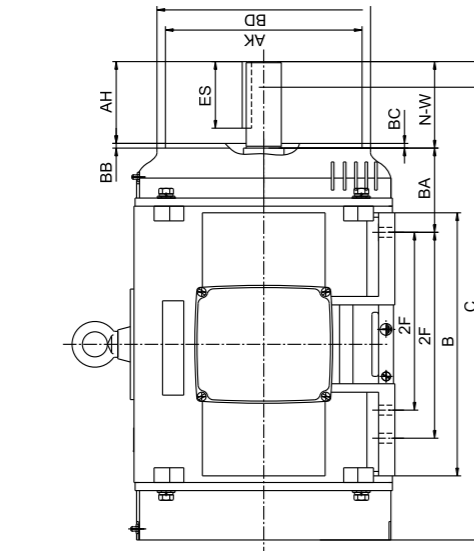
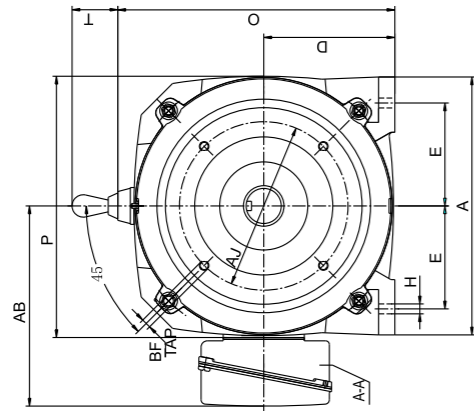

Type	A	B	C	D	E	2F	H	O+T	P	A-A	AB	BA	N-W	ES	S	TH	R	U	AH	AJ	AK	BB	BC	BD	Be Hole		
																									Number	Tap Size	Belt Penetration Allowance
254/6TC	12.2	9.84/11.57	20.67/22.4	6.25	5	8.25/10	4-φ0.53	14.55	12.8	1-1/4	11.1	4.25	4	2.875	0.375	0.375	1.416	1.625	3.75	7.25	8.5	0.25	0.25	10	4	1/2-13	0.75
284/6TC	12.76	11.26/12.76	23.82/25.32	7	5.5	9.5/11	4-φ0.53	16.84	14.76	1-1/2	13.18	4.75	4.62	3.25	0.5	0.5	1.591	1.875	4.38	9	10.5	0.25	0.25	11.25	4	1/2-13	0.75
324/6TC	14.88	12.68/14.17	26.26/27.76	8	6.25	10.5/12	4-φ0.66	18.82	16.69	2	14.09	5.25	5.25	3.875	0.5	0.5	1.845	2.125	5	11	12.5	0.25	0.25	14	4	5/8-11	0.94
364/5TC	16.38	13.43/14.41	29.13/30.13	9	7	11.25/12.25	4-φ0.66	21.05	18.31	3	16.58	5.88	5.88	4.15	0.625	0.625	2.021	2.375	5.62	11	12.5	0.25	0.25	14	8	5/8-11	0.94
404/5TC	19.69	14.96/16.54	33.1/34.6	10	8	12.25/13.75	4-φ0.81	23.78	20.24	3	20.08	6.62	7.25	5.625	0.75	0.75	2.45	2.875	7	11	12.5	0.25	0.25	15.5	8	5/8-11	0.94
444/5TC	22.05	17.32/19.29	37.7/39.7	11	9	14.5/16.5	4-φ0.81	26.35	22.05	3	20.86	7.5	8.5	6.91	0.875	0.875	2.88	3.375	8.25	14	16	0.25	0.25	18	8	5/8-11	0.94

# EISA-Compliant High Efficient Cast Iron Motors

C Face TEFC

## Applications:

General purpose use on pumps, fans, blowers, compressors, conveyors, and other industrial machinery installed in damp, dusty. Or dirty environments. Additionally, cast iron frame motors may be suitable for the process industries.

## Features:

- Service Factor 1.15
- EISA-Compliant High efficient
- Class F insulation
- TEFC enclosure
- Cast Iron frame, end shield
- Maximum 40 °C ambient temperature
- Design C high torque



HP	RPM	Voltage	Frame	Catalog Number		FL Eff %	FL Amps 460V	Ship WT. (lbs.)
				Footed	Footless			
1	1800	208-230/460V	143TC	HE14T12	HE14T22	82.5	1.49	47
	1200	208-230/460V	145TC	HE16T12	HE16T22	80	1.7	47
1.5	3600	208-230/460V	143TC	HE322T12	HE322T22	82.5	1.99	45
	1800	208-230/460V	145TC	HE324T12	HE324T22	84	2.05	54
2	1200	208-230/460V	182TC	HE326T11	HE326T21	85.5	2.38	77
	3600	208-230/460V	145TC	HE22T12	HE22T22	84	2.6	47
2	1800	208-230/460V	145TC	HE24T12	HE24T22	84	2.7	56
	1200	208-230/460V	184TC	HE26T11	HE26T21	86.5	3.2	88
3	3600	208-230/460V	182TC	HE32T12	HE32T22	85.5	3.59	106
	1800	208-230/460V	182TC	HE34T11	HE34T21	87.5	3.9	97
	1200	208-230/460V	213TC	HE36T11	HE36T21	87.5	4.15	123
5	3600	208-230/460V	184TC	HE52T11	HE52T21	87.5	5.9	114
	1800	208-230/460V	184TC	HE54T11	HE54T21	87.5	6.48	102
5	1200	208-230/460V	215TC	HE56T11	HE56T21	87.5	6.8	175
	3600	208-230/460V	213TC	HE72T11	HE72T21	88.5	8.66	150
7.5	1800	208-230/460V	213TC	HE74T11	HE74T21	89.5	9.53	150
	1200	208-230/460V	254TC	HE76T11	HE76T21	89.5	9.53	262
10	3600	208-230/460V	215TC	HE102T11	HE102T21	89.5	11.7	150
	1800	208-230/460V	215TC	HE104T11	HE104T21	89.5	12.8	165
	1200	208-230/460V	256TC	HE106T11	HE106T21	89.5	13.4	304





# Three Phase Roll Steel Motors

## C Face TEFC

### Applications:

Designed for pumps, fans, compressors, material handling and other general purpose applications in damp dusty or dirty environment.

### Features:

Class F Insulation  
Rolled Steel Frame  
Aluminum End Shields  
Design B

Double Shielded Bearings  
40 °C Ambient  
High Efficient



HP	RPM	Voltage	Frame	Catalog Number		SF	Full load Eff.	Full load Amps	Ship WT. (lbs.)
				Footed	Footless				
1/4	3600	230/460	48C	RT142T11	RT142T21	1	68.0	1.11/0.55	17
	1800	230/460	48C	RT144T11	RT144T21	1	60.2	1.25/0.63	19
1/3	3600	230/460	48C	RT132T11	RT132T21	1	72.0	1.15/0.57	21
	3600	230/460	56C	RT132T12	RT132T22	1	72.0	1.16/0.58	23
	1800	230/460	48C	RT134T11	RT134T21	1	67.0	1.32/0.66	23
1/2	1800	230/460	56C	RT134T12	RT134T22	1	67.0	1.38/0.69	22
	3600	230/460	48C	RT122T11	RT122T21	1	74.0	1.57/0.78	23
	3600	230/460	56C	RT122T12	RT122T22	1	74.0	1.65/0.83	26
3/4	1800	230/460	48C	RT124T11	RT124T21	1	70.0	1.7/0.85	26
	1800	230/460	56C	RT124T12	RT124T22	1	70.0	1.84/0.92	23
	3600	230/460	56C	RT342T11	RT342T21	1	76.0	2.34/1.17	30
1	1800	230/460	56C	RT344T11	RT344T21	1	74.0	2.57/1.28	25
	3600	230/460	143TC	RT12T11	RT12T21	1.25	77.0	3.13/1.57	39
1 1/2	1800	230/460	56C	RT14T11	RT14T21	1.25	85.5	2.98/1.49	42
	3600	230/460	143TC	RT322T11	RT322T21	1.25	84.0	3.96/1.98	51
2	1800	230/460	143TC	RT324T11	RT324T21	1.25	86.5	4.20/2.10	50
	3600	230/460	145TC	RT22T11	RT22T21	1.25	85.5	5.31/2.65	55
3	1800	230/460	56C	RT24T11	RT24T21	1.25	86.5	5.65/2.83	52
	1800	230/460	145TC	RT24T12	RT24T22	1.25	86.5	5.51/2.76	53
5	3600	230/460	145TC	RT32T11	RT32T21	1.25	86.5	7.17/3.59	83
	1800	230/460	182TC	RT34T11	RT34T21	1.25	89.5	7.81/3.91	76
7 1/2	3600	230/460	184TC	RT52T11	RT52T21	1.25	88.5	11.5/5.77	98
	1800	230/460	184TC	RT54T11	RT54T21	1.25	89.5	13.1/6.57	92
10	3600	230/460	184TC	RT72T11	RT72T21	1.25	89.5	17.5/8.76	87
	1800	230/460	213TC	RT74T11	RT74T21	1.25	91.7	18.1/9.17	128
10	3600	230/460	215TC	RT102T11	RT102T21	1.25	90.2	23.7/11.9	123
	1800	230/460	215TC	RT104T11	RT104T21	1.25	91.7	24.7/12.4	136

# NEMA Full Line Motors

## Three Phase Roll Steel Motors

### C Face TEFC

### Mounting and overall dimensions TEFC 48C-215TC

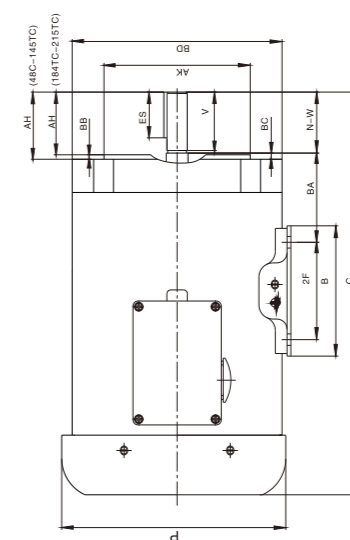
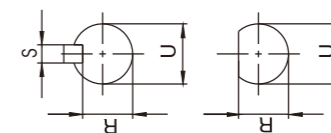
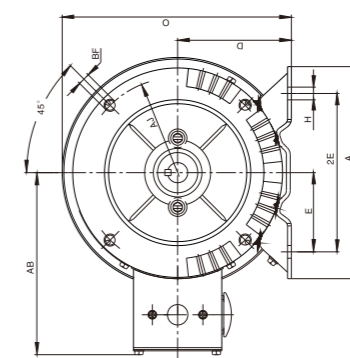

Frame size	AB	BA	MAX A	MAX B	MAX BB	MAX BD	C	D	E	2F	H	N-W	O	P	R	S	U	MIN ES	MIN AA	AH	BF	BC	AJ	AK	MIN V
48C	5.3	2.5	6	3.8	0.16	5.625	10	3.0	2.12	2.75	0.34	1.5	5.83	5.66	0.453	0.5	1/2	1/2	1.69	1/4-20	-0.19	3.75	3	1.125	
56C	5.6	2.75	6.5	4.2	0.16	6.5	12.7	3.5	2.44	3	0.34	1.88	6.7	7.08	0.517	0.625	1/2	1/2	2.06	3/8-16	-0.19	5.875	4.5	1.5	
143TC	5.6	2.75	7	6.18	0.16	6.5	14.6	3.5	2.75	4	0.34	2.25	6.7	7.08	0.771	0.875	3/4	3/4	2.12	1/2-13	+0.12	5.875	4.5	2	
145TC	5.6	2.75	7	6.18	0.16	6.5	14.6	3.5	2.75	5	0.41	2.75	9.25	9.65	0.986	1.125	3/4	3/4	2.62	1/2-13	+0.12	7.25	8.5	2.5	
182TC	7.2	3.5	8.5	6.5	0.25	9	18.5	4.5	3.75	5.5	0.41	2.75	9.25	9.65	0.986	1.125	3/4	3/4	2.62	1/2-13	+0.12	7.25	8.5	2.5	
213TC	7.5	4.25	9.5	8	0.25	9	20.5	5.25	4.25	7.0	0.41	3.38	9.84	10.0	1.201	1.375	1	1	3.12	1/2-13	+0.25	7.25	8.5	3.12	
215TC	7.5	4.25	9.5	8	0.25	9	20.5	5.25	4.25	7.0	0.41	3.38	9.84	10.0	1.201	1.375	1	1	3.12	1/2-13	+0.25	7.25	8.5	3.12	

Single Phase Motors • Premium efficient Motors • High efficient Motors • C Face Motors • Severe Duty Motors • IEEF-841 Motors • Explosion Proof Motors • Special Purpose Motors • Farm Duty Single Phase Motors • Belted Fan & Blower Motors • Single Phase Auger Motors

Single Phase Motors • Premium efficient Motors • High efficient Motors • C Face Motors • Severe Duty Motors • IEEF-841 Motors • Explosion Proof Motors • Special Purpose Motors • Farm Duty Single Phase Motors • Belted Fan & Blower Motors • Single Phase Auger Motors

# Three Phase Roll Steel Motors

## C Face ODP

### Applications:

Designed for pumps, fans, compressors, material handling and other general purpose applications where contaminants are minimal.

### Features:

- Class F Insulation
- Rollled Steel Frame
- Aluminum End Shields
- Design B
- Double Shielded Bearings
- 40 °C Ambient
- High Efficient



HP	RPM	Voltage	Frame	Catalog Number		SF	Full load Eff.	Full load Amps	Ship WT. (lbs.)
				Footed	Footless				
1/4	3600	230/460	48C	RT142D11	RT142D21	1.35	68.1	1.11/0.55	17
	1800	230/460	48C	RT144D11	RT144D21	1.35	60.2	1.25/0.63	19
1/3	3600	230/460	48C	RT132D11	RT132D21	1.35	72.0	1.15/0.57	21
	3600	230/460	56C	RT132D12	RT132D22	1.35	72.0	1.16/0.58	23
	1800	230/460	48C	RT134D11	RT134D21	1.35	67.0	1.32/0.66	23
	1800	230/460	56C	RT134D12	RT134D22	1.35	67.0	1.38/0.69	22
1/2	3600	230/460	48C	RT142D11	RT142D21	1.25	74.0	1.53/0.76	23
	3600	230/460	56C	RT142D12	RT142D22	1.25	74.0	1.61/0.83	26
	1800	230/460	48C	RT144D11	RT144D21	1.25	70.0	1.7/0.85	26
	1800	230/460	56C	RT144D12	RT144D22	1.25	70.0	1.84/0.92	23
3/4	3600	230/460	48C	RT342D11	RT342D21	1.25	76.0	2.34/1.17	30
	1800	230/460	56C	RT344D11	RT344D21	1.25	74.0	2.57/1.28	25
1	3600	230/460	143TC	RT12D11	RT12D21	1.15	77.0	3.13/1.57	39
	1800	230/460	56HC	RT14D11	RT14D21	1.15	85.5	2.89/1.49	42
1 1/2	3600	230/460	143TC	RT322D11	RT322D21	1.15	84.0	3.96/1.98	52
	1800	230/460	56HC	RT324D11	RT324D21	1.15	86.5	4.2/2.1	50
2	3600	230/460	145TC	RT222D11	RT222D21	1.15	85.5	5.31/2.65	54
	1800	230/460	145TC	RT224D11	RT224D21	1.15	86.5	5.65/2.83	52
	1800	230/460	56HZC	RT224D12	RT224D22	1.15	86.5	5.51/2.76	53
3	3600	230/460	182TC	RT32D11	RT32D21	1.15	85.5	7.26/3.63	82
	1800	230/460	182TC	RT34D11	RT34D21	1.15	89.5	7.81/3.91	76
5	3600	230/460	182TC	RT52D11	RT52D21	1.15	86.5	11.8/5.9	98
	1800	230/460	184TC	RT54D11	RT54D21	1.15	89.5	13.1/6.57	92
7 1/2	3600	230/460	184TC	RT72D11	RT72D21	1.15	88.5	17.7/8.86	88
	1800	230/460	213TC	RT74D11	RT74D21	1.15	91.0	18.3/9.14	127
10	3600	230/460	213TC	RT102D11	RT102D21	1.15	89.5	23.9/12	122
	1800	230/460	215TC	RT104D11	RT104D21	1.15	91.7	24.7/12.4	136

# NEMA

## Full Line Motors

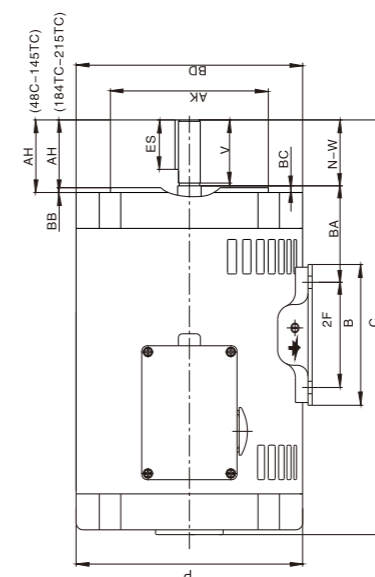
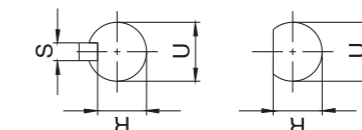
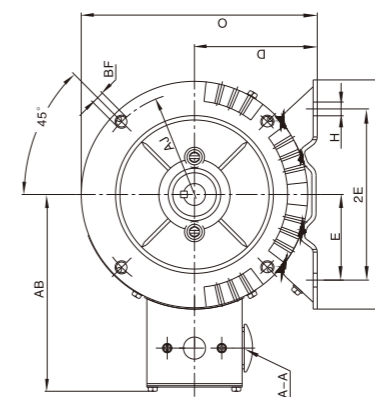

## Three Phase Roll Steel Motors

### C Face ODP

## Mounting and overall dimensions ODP 48C-215TC

Frame size	AB	BA	MAX A	MAX B	MAX BB	MAX BD	C	D	E	2F	H	N-W	O	P	R	S	U	MIN ES	MIN AA	AH	BF	BC	AJ	AK	MIN V
48C	5.3	2.5	6	3.8	0.16	5.625	10	3.0	2.12	2.75	0.34	1.5	5.83	5.66	0.453	0.5	0.5	1/2	1.69	1/4-20	-0.19	3.75	3	1.125	
56C	5.6	2.75	6.5	4.2	0.16	6.5	11.4	3.5	2.44	3	0.34	1.88	6.7	7.08	0.517	0.188	0.625	1/2	2.06	3/8-16	-0.19	5.875	4.5	1.5	
143TC	5.6	2.75	7	6.18	0.16	6.5	13.3	3.5	2.75	4	0.34	2.25	6.7	7.08	0.771	0.188	0.875	3/4	2.12	1/2-13	+0.125	5.875	4.5	2	
145TC	5.6	2.75	7	6.18	0.16	6.5	13.3	3.5	2.75	5	0.34	2.75	6.7	7.08	0.986	0.25	1.125	3/4	2.62	1/2-13	+0.12	7.25	8.5	2.5	
182TC	7.2	3.5	8.5	6.5	0.25	9	16.5	4.5	3.75	5.5	0.41	2.75	9.25	9.65	1.201	0.312	1.375	1	3.12	1/2-13	+0.25	7.25	8.5	3.12	
184TC	7.2	3.5	8.5	6.5	0.25	9	16.5	4.5	3.75	5.5	0.41	2.75	9.25	9.65	1.201	0.312	1.375	1	3.12	1/2-13	+0.25	7.25	8.5	3.12	
213TC	7.5	4.25	9.5	8	0.25	9	18	5.25	4.25	7.0	0.41	3.38	9.84	9.0	1.201	0.312	1.375	1	3.12	1/2-13	+0.25	7.25	8.5	3.12	
215TC	7.5	4.25	9.5	8	0.25	9	18	5.25	4.25	7.0	0.41	3.38	9.84	9.0	1.201	0.312	1.375	1	3.12	1/2-13	+0.25	7.25	8.5	3.12	

Single Phase Motors • Premium efficient Motors • High efficient Motors • C Face Motors • Severe Duty Motors • IEEE-841 Motors • Explosion Proof Motors • Special Purpose Motors • Farm Duty Single Phase Motors • Belted Fan & Blower Motors • Single Phase Auger Motors

Single Phase Motors • Premium efficient Motors • High efficient Motors • C Face Motors • Severe Duty Motors • IEEE-841 Motors • Explosion Proof Motors • Special Purpose Motors • Farm Duty Single Phase Motors • Belted Fan & Blower Motors • Single Phase Auger Motors

# EISA-Compliant High Efficient Aluminum Motors

## C Face TEFC

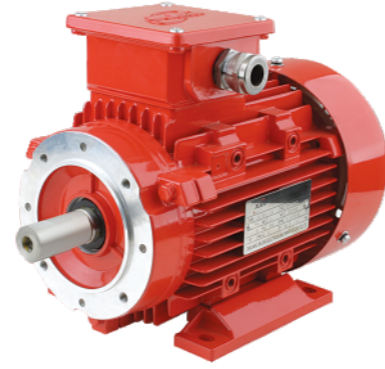

### Applications:

General purpose use on pumps, fans, blowers, compressors, conveyors, reducers and other industrial machinery .

### Features:

- Service Factor 1.15
- EISA-Compliant High efficient
- Class F insulation
- TEFC enclosure
- Removable Base
- Aluminum frame, end shield
- Maximum 40°C ambient temperature
- Design C high torque
- D flange available
- Low noise

HP	RPM	Voltage	Frame	Catalog Number		FL Eff %	FL Amps 460V	Ship WT. (lbs.)
				Footed	Footless			
1/4	3260	208-230/460	48C	AE142T11	AE142T21	65	0.96-0.9/0.43	17
	1570	208-230/460	48C	AE144T11	AE144T21	60	1.14-1/0.52	18
	1020	208-230/460	56C	AE146T11	AE146T21	56	1.35-1.2/0.61	23
1/3	3260	208-230/460	48C	AE132T11	AE132T21	68	1.26-1.1/0.57	18
	1595	208-230/460	48C	AE134T11	AE134T21	65	1.44-1.3/0.65	19
1/2	3285	208-230/460	48C	AE122T11	AE122T21	70	1.81-1.6/0.82	19
	1595	208-230/460	56C	AE124T11	AE124T21	67	2.04-1.8/0.92	26
	1060	208-230/460	56C	AE126T11	AE126T21	62	2.37-2.1/1.07	24
3/4	3285	208-230/460	48C	AE342T11	AE342T21	73	2.55-2.3/1.15	20
	1665	208-230/460	56C	AE344T11	AE344T21	71.1	2.86-2.6/1.29	28
	1060	208-230/460	143TC	AE346T11	AE346T21	65	3.26-3/1.48	27
1	3405	208-230/460	56C	AE12T11	AE12T21	75.1	3.34-3/1.51	26
	1665	208-230/460	143TC	AE14T11	AE14T21	73.1	3.75-3.4/1.69	29
	1090	208-230/460	145TC	AE16T11	AE16T21	69	4.19-3.8/1.89	29
	815	208-230/460	182TC	AE18T11	AE18T21	71	4.38-4/1.98	57
1 1/2	3405	208-230/460	143TC	AE322T11	AE322T21	77	4.72-4.3/2.13	28
	1665	208-230/460	145TC	AE324T11	AE324T21	76.3	5.2-4.7/2.35	30
	1090	208-230/460	182TC	AE326T11	AE326T21	72.1	5.8-5.2/2.62	57
	815	208-230/460	184TC	AE328T11	AE328T21	73	6.06-5.5/2.74	62
2	3405	208-230/460	145TC	AE22T11	AE22T21	79	6.27-5.7/2.84	30
	1665	208-230/460	145TC	AE24T11	AE24T21	78.6	6.71-6.1/3.03	31
	1100	208-230/460	184TC	AE26T11	AE26T21	76.1	7.29-6.6/3.3	64
	825	208-230/460	213TC	AE28T11	AE28T21	75	8.05-7.3/3.64	84
3	3405	208-230/460	145TC	AE32T11	AE32T21	81.1	8.86-8/4.01	33
	1690	208-230/460	182TC	AE34T11	AE34T21	81.2	9.28-8.4/4.2	62
	1150	208-230/460	213TC	AE36T11	AE36T21	81.1	9.91-9/4.48	84
5	845	208-230/460	215TC	AE38T11	AE38T21	78	11-10/4.99	93
	3455	208-230/460	184TC	AE52T11	AE52T21	84.4	13.8-13/6.25	62
	1720	208-230/460	184TC	AE54T11	AE54T21	84.3	14.9-13/6.72	66
7 1/2	1150	208-230/460	215TC	AE56T11	AE56T21	82.1	16.5-15/7.44	97
	860	208-230/460	254TC	AE58T11	AE58T21	81	17.4-16/7.85	152
	3480	208-230/460	184TC	AE72T11	AE72T21	85.9	20.2-18/9.13	86
10	1725	208-230/460	213TC	AE74T11	AE74T21	85.8	21.4-19/9.69	93
	1150	208-230/460	254TC	AE76T11	AE76T21	84.1	23.6-21/10.7	150
	860	208-230/460	256TC	AE78T11	AE78T21	83	24.9-22/11.2	192
15	3480	208-230/460	215TC	AE102T11	AE102T21	87.2	27.1-25/12.3	110
	1725	208-230/460	215TC	AE104T11	AE104T21	87.1	28.5-26/12.9	107
	1150	208-230/460	256TC	AE106T11	AE106T21	86.1	31.4-28/14.2	161
20	3515	208-230/460	254TC	AE152T11	AE152T21	88.5	38.8-35/17.5	150
	1750	208-230/460	254TC	AE154T11	AE154T21	88.5	41.1-37/18.6	163
25	3515	208-230/460	256TC	AE202T11	AE202T21	89.5	52.3-47/23.6	181
	1750	208-230/460	256TC	AE204T11	AE204T21	89.5	54.7-49/24.7	191
30	3515	208-230/460	284TC	AE252T11	AE252T21	90.2	63.3-57/28.6	225
	1760	208-230/460	284TC	AE254T11	AE254T21	90.1	66.3-60/30	223
30	3525	208-230/460	286TC	AE302T11	AE302T21	90.7	74.8-68/33.8	265
	1760	208-230/460	286TC	AE304T11	AE304T21	90.6	78.4-71/35.4	247

# NEMA Full Line Motors

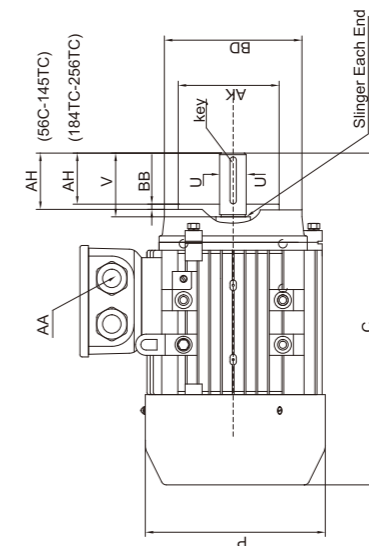
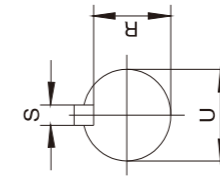
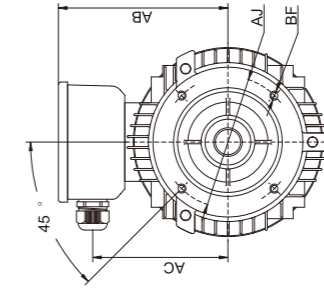

## EISA-Compliant High Efficient Aluminum Motors

### C Face TEFC

### Mounting and overall dimensions 56C, 143TC-286TC

NEMA Frame	A	B	C	D	E	2F	H	Key	N	O	P	S	R	U	N-W	AA	AB	AC	BA
48	6	3.6	10.5	3	2.12	2.75	0.34	1.41	1.62	5.85	5.4	0.188	0.453	0.5	1.5	0.5	4.65	3.5	2.5
56	6.5	4	13.8	3.5	2.44	3	0.34	1.41	2	7.34	7.5	0.188	0.517	0.625	1.88	0.5	5.5	4.5	2.75
143T		4.9	13.2			4													
145T	6.8	5.9	14.1	3.5	2.75	5	0.38	1.41	2.5	7.48	7.5	0.188	0.771	0.875	2.25	0.75	5.5	4.5	2.25
182T	8.62	6.5	18	4.5	3.75	5.5	0.41	1.78	2.81	9.23	8.7	0.25	0.986	1.125	2.75	0.75	7.12	5.75	2.75
184T																			
213T	9.62	8.12	19	5.5	4.25	7	0.41	2.41	3.88	10.99	10.2	0.312	1.201	1.375	3.38	1	9.22	7.43	3.5
215T																			
254T	11.5	11.5	23.6	5	8.25	10	0.53	2.91	4.2	12.96	12.4	0.375	1.418	1.625	4	1.25	10.48	8.66	4.25
256T																			
284T	12.76	12.75	29	7	9.5	11	0.53	3.28	4.88	14.74	14	0.5	1.591	1.875	4.63	1.5	12.46	10.14	4.75
286T																			

# Medium Voltage Motors

## Applications:

waste management facilities, chemical plants, tropical climates and other processing applications requiring corrosion protection from severe conditions.

## Features:

- TEFC enclosure
- Service Factor 1.15
- Design B
- Class F insulation
- Class B temperature rise
- Cast iron and Fabricated steel frame available
- Copper bar rotor
- Large size terminal box
- Maximum 40 °C ambient temperature
- Low noise, ≤85dBA



HP	RPM	Voltage	Frame	Model Number	FL Amps (A)	FL Eff. (%)	Approx. Wt. (lbs.)
350	1200	2300/4160	5009	MV35061	49.4	94	4882
350	1800	2300/4160	5007	MV35041	44.4	93.8	4140
350	3600	2300/4160	5007	MV35021	42.4	94	4161
350	900	2300/4160	5811	MV35081	50.1	94	6787
400	1200	2300/4160	5010	MV40061	54.8	94.5	5180
400	1800	2300/4160	5008	MV40041	50.6	94	4367
400	3600	2300/4160	5009	MV40021	48.3	94.3	4882
400	900	2300/4160	5811	MV40081	57.2	94.1	6787
450	1200	2300/4160	5011	MV45061	62.4	94.5	5345
450	1800	2300/4160	5009	MV45041	56.8	94.3	4882
450	3600	2300/4160	5011	MV45021	53.7	94.3	5273
450	900	2300/4160	5812	MV40081	63.4	94.2	7261
500	1200	2300/4160	5811	MV50061	67.6	94.8	6787
500	1800	2300/4160	5011	MV50041	62	94.9	5345
500	3600	2300/4160	5811	MV50021	60.4	95.2	6530
600	1200	2300/4160	5812	MV60061	80.7	95.3	7261
600	1800	2300/4160	5811	MV60041	75.6	95.5	6787
600	3600	2300/4160	5812	MV60021	72.7	95.8	7014
700	1200	2300/4160	6809	MV70061	94.2	95.5	8652
700	1800	2300/4160	5812	MV70041	87.7	95.8	7261
700	3600	2300/4160	6809	MV70021	84.1	95.8	8174
800	1200	2300/4160	6810	MV80061	106.3	95.7	9084
800	1800	2300/4160	6809	MV80041	100.8	95.7	8404
800	3600	2300/4160	6809	MV80021	97.1	95.8	8174
900	1800	2300/4160	6810	MV90041	112.2	95.9	8837
1000	1800	2300/4160	6810	Mv100041	124.6	96	8837

# NEMA Full Line Motors

## Medium Voltage Motors Mounting and overall dimensions N5009-N6810

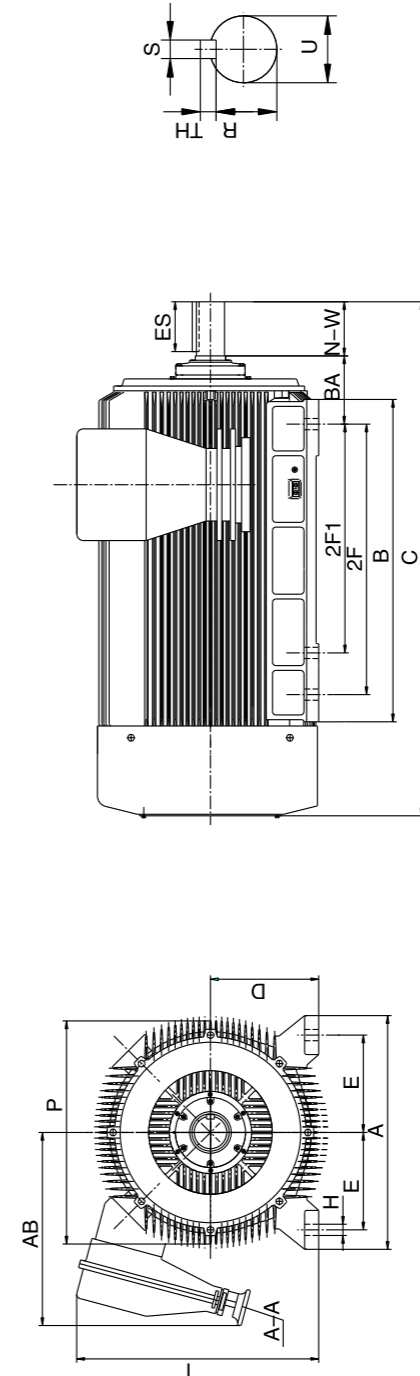

FRAME NO.	POLES	A	B	C	D	E	2F	(2F1)	H	P	O+T	O+T1	AB	BA	U	N-W	ES	S	R	V
N5009	2	24.8	33.86	69.9	12.5	10	28	22	1.1	27.8	30.4	33.4	27.8	8.5	2.625	5.5	4.75	2.275	5.3	
	4~10	24.8	33.86	67.4	12.5	10	28	22	1.1	27.8	30.4	33.4	27.8	8.5	3.75	6.7	5.5	0.875	3.261	6.5
N5011	4~10	24.8	41.85	75.2	12.5	10	36	32	1.1	27.8	30.4	33.4	27.8	8.5	3.75	6.7	5.5	0.875	3.261	6.5
	2	28	33.86	78.6	14.5	11.5	28	25	1.1	32.3	34.2	36.9	29.8	10	2.875	5.5	4.75	2.45	5.3	
N5808	4~10	28	33.86	73.3	14.5	11.5	28	25	1.1	32.3	34.2	36.9	29.8	10	4.375	8.3	6.7	1	3.817	8.1
	2	28	41.85	86.1	14.5	11.5	36	32	1.1	32.3	34.2	36.9	29.8	10	2.875	5.5	4.75	2.45	5.3	
N5810	4~10	28	41.85	80.7	14.5	11.5	36	32	1.1	32.3	34.2	36.9	29.8	10	4.375	8.3	6.7	1	3.817	8.1
	2	31.5	47.24	85.5	15.75	13.5	40	32	1.38	35.5	37	40.9	33.1	11	3.125	6.7	5.5	0.75	2.704	6.5
N6310	4~10	31.5	47.24	80.7	15.75	13.5	40	32	1.38	35.5	37	40.9	33.1	11	4.375	8.3	6.7	1	3.817	8.1
	2	33.9	53.54	92	17	13.5	45	36	1.38	37.8	—	44	—	11.5	3.375	6.7	5.5	0.875	2.88	6.5
N6810	4~10	33.9	53.54	90.2	17	13.5	45	36	1.38	37.8	—	44	—	11.5	4.875	8.3	6.7	1.25	4.169	8.1

# Crusher Motors

## Foot Mount TEFC

### Applications:

Belt-driven rock crushers, pellet mills, and other applications requiring motors rated for severe duty service and high starting torques.

### Features:

Features: Class F Insulation High efficient Design C, high torque  
 Service Factor 1.15 TEFC enclosure Not suitable for direct coupled drive  
 Drive end roller bearing

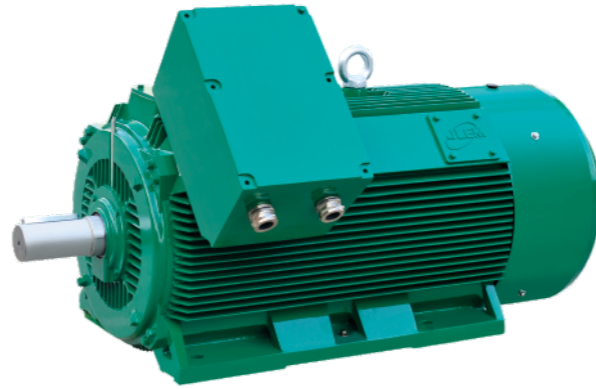

HP	RPM	Voltage	Frame	Model Number	FL Amps (A)	FL Eff. (%)	Approx. Wt. (lbs.)
100	1800	208-230/460	405T	CU10041	115	94.5	1184
100	1200	208-230/460	444T	CU10061	121	94.1	1061
125	1800	208-230/460	444T	CU12541	144	94.5	1344
125	1200	208-230/460	445T	CU12561	148	94.1	1750
150	1800	208-230/460	445T	CU15041	166	95	1637
150	1200	208-230/460	447T	CU15061	176	95	1851
200	1800	208-230/460	445T	CU20041	230	95	2750
200	1200	460	449T	CU20061	241	95	2583
250	1800	460	449T	CU25041	282	95	2583
250	1800	460	505Z	CU25042	276	95	2429
250	1800	460	505UZ	CU25043	276	95	2429
250	1200	460	449T	CU25061	300	95	2832
250	1200	460	586/7	CU25062	289	95	3806
250	1200	460	586/7UZ	CU25063	289	95	3806
300	1800	460	449T	CU30041	334	95.4	2809
300	1800	460	586/7	CU30042	323	95.4	3897
300	1800	460	586/7UZ	CU30043	323	95.4	2914
300	1200	460	449T	CU30061	355	95	2914
300	1200	460	586/7	CU30062	337	95	4260
300	1200	460	586/7UZ	CU30063	337	95	4260
350	1800	460	586/7	CU35041	378	95.4	4078
350	1800	460	586/7UZ	CU35042	378	95.4	4078
350	1200	460	586/7	CU35061	390	95	4269
350	1200	460	586/7UZ	CU35062	390	95	4269
400	1800	460	586/7	CU40041	430	95.4	4224
400	1800	460	586/7UZ	CU40042	430	95.4	4224
400	1200	460	586/7	CU40061	448	95	4540
400	1200	460	586/7UZ	CU40062	448	95	4540
450	1800	460	586/7	CU45041	478	95.4	4635
450	1200	460	586/7	CU45061	501	95.8	4635
500	1800	460	586/7	CU50041	539	95.8	4768
500	1800	460	586/7UZ	CU50042	539	95.8	4768
500	1200	460	586/7	CU50061	557	95	4882
500	1200	460	586/7UZ	CU50062	557	95	4882

# NEMA

## Full Line Motors

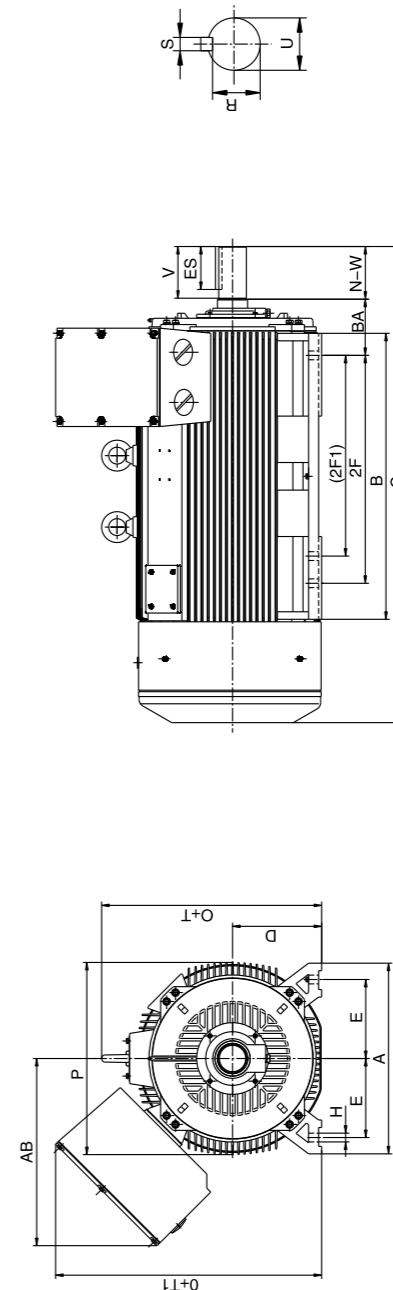

## Crusher Duty Motors

### Foot Mount TEFC

## Mounting and overall dimensions 405T-586/7UZ

FRAME	A	B	C	D	2E	2F	(2F1)	H	P	T	AA	AB	BA	S	TH	ES	R	N-W	U
405T	19.22	18.25	41.36	10	16	13.75	12.25	4-0.81	21.56	25.6	1-NPT3"	21.12	6.62	0.75	0.75	5.65	2.45	7.25	2.875
444T	22.05	18.75	47.8	11	18	14.5	-	4-0.81	25.83	26.54	1-NPT3"	22.24	7.5	0.875	0.875	6.91	2.88	8.5	3.375
445T	22.05	19.29	48.1	11	18	16.5	14.5	4-0.81	25.83	26.54	1-NPT3"	22.24	7.5	0.875	0.875	6.91	2.88	8.5	3.375
447T	22.05	22.83	59.54	11	18	20	-	4-0.81	26.77	27.83	1-NPT3.5"	22.95	7.5	0.875	0.875	8.5	2.88	10.125	3.375
449T	22.05	27.83	64.54	11	18	25	20	4-0.81	26.77	27.83	1-NPT3.5"	22.95	7.5	0.875	0.875	8.5	2.88	10.125	3.375
505T	24.8	20.87	56.12	12.5	20	18	16	4-0.94	26.77	30.2	1-NPT4"	21.85	8.5	1	1	10	3.309	11.625	3.875
586/7UZ	28	29.72	71.02	14.5	23	25	22	6-1.1	33	33.2	2-NPT3"	30.94	10	1	1	10	3.817	11.625	4.375

## IEEE-841 Motors

### Applications:

Above-ground mines ,cement plants,chemical plants and paper plants and other extreme environmental conditions.

### Features:

- Full compliance with IEEE-841 (2009) standard
- Motor efficiency meets or exceeds NEMA Premium efficiency level
- Inverter applkation meets NEMA MG-1 part 31 standard
- Inverter rate: CT 20:1 , VT 1000:1
- Class B temperature. rise ,Class F insulation , major components of stator coil dass H
- Corona resistance enameled wire
- Low winding & bearing temperature
- High torque characteristics
- Inpro-Seal (D.E. & O.D.E.)
- Oversized, Regreasable bearings from 140T to N5808
- Polyrex-thickened grease, Extended grease pipes
- IP 56 for 140T frame & larger
- Class 1, Division 2,Groups A,B,C,D - T3C
- Low noise level
- Low Vibration: 0.04 inches per second or less



HP	RPM	Frame	Catalog Number	FL Eff %	FL Amps 460V	FL Amps 575V	Ship WT. (lbs.)
1	1800	143T	TE14T01	85.5	1.15	6.2/3.1	Yes
	1200	145T	TE16T01	82.5	1.15	8.0/4.0	Yes
1.5	3600	143T	TE322T01	84	1.15	10.8/5.4	Yes
	1800	145T	TE324T01	86.5	1.00	15.0/7.5	Yes
	1200	182T	TE326T01	87.5	1.15	14.4/7.2	Yes
2	3600	145T	TE22T01	85.5	1.15	16.2/8.1	Yes
	1800	145T	TE24T01	86.5	1.15	16.2/8.1	Yes
	1200	184T	TE26T01	88.5	1.00	23.6/11.8	Yes
3	3600	182T	TE32T01	87.5	1.00	20.0/10.0	Yes
	1800	182T	TE34T01	89.5	1.00	14.5	Yes
	1200	213T	TE36T01	89.5	1.00	22.0	Yes
5	3600	184T	TE52T01	89.5	1.00	23.0	No
	1800	184T	TE54T01	89.5	1.00	30.0	No
	1200	215T	TE56T01	89.5	1.00	38.0	No

HP	RPM	Frame	Catalog Number	FL Eff %	FL Amps 460V	FL Amps 575V	Ship WT. (lbs.)
7.5	3600	213T	TE72T01	91	8.63	6.90	134
	1800	213T	TE74T02	91.7	9.29	7.43	165
	1200	254T	TE76T03	91	9.73	7.78	282
10	3600	215T	TE102T04	91.7	11.5	9.20	173
	1800	215T	TE104T05	91.7	12.6	10.08	172
	1200	256T	TE106T06	61	13.3	10.64	316
15	3600	254T	TE152T07	91.7	16.9	13.52	280
	1800	254T	TE154T08	92.4	18	14.40	291
	1200	284T	TE156T09	91.7	17.3	13.84	360
20	3600	256T	TE202T10	92.4	22.9	18.32	313
	1800	256T	TE204T11	93	24.4	19.52	324
	1200	286T	TE206T12	91.7	24.1	19.28	503
25	3600	284TS	TE252T13	93	28.4	22.72	353
	1800	284T	TE254T14	93.6	29.5	23.60	481
	1200	324T	TE256T15	93	30.5	24.40	605
30	3600	286TS	TE302T16	93	33.4	26.72	428
	1800	286T	TE304T17	93.6	35.1	28.08	525
	1200	326T	TE306T18	93	35.8	28.64	673
40	3600	324TS	TE402T19	93.6	45.8	36.64	561
	1800	324T	TE404T20	94.1	48.3	38.64	640
	1200	364T	TE406T21	94.1	47.1	37.68	1076
50	3600	326TS	TE502T22	94.1	55.5	44.40	607
	1800	326T	TE504T23	94.5	60.6	48.48	662
	1200	365T	TE506T24	94.1	58	46.40	1127
60	3600	364TS	TE602T25	94.1	68.3	54.64	992
	1800	364T	TE604T26	95	68.4	54.72	1036
	1200	404T	TE606T27	94.5	70.4	56.32	1346
75	3600	365TS	TE752T28	95	82.6	66.08	1025
	1800	365T	TE754T29	95.4	82.3	65.84	1047
	1200	405T	TE756T30	94.5	87	69.60	1478
100	3600	405TS	TE1002T31	95	111	88.80	1361
	1800	405T	TE1004T31	95.4	112	89.60	1302
	1200	444T	TE1006T31	95	121	96.80	2006
125	3600	444TS	TE1252T31	95	133	106.40	1794
	1800	444T	TE1254T31	95.4	138	110.40	1841
	1200	445T	TE1256T31	95	145	116.00	2082
150	3600	445TS	TE1502T31	95.4	161	128.80	1865
	1800	445T	TE1504T31	95.8	170	136.00	1940
	1200	447T	TE1506T31	95.8	174	139.20	2738
200	3600	447TS	TE2002T31	95.8	221	176.80	2072
	1800	447T	TE2004T31	96.2	230	184.00	2216
	1200	449T	TE2006T31	95.8	223	178.40	2506









# Close-Coupled Pump Motors

Mounting and overall dimensions  
**JM, JP**

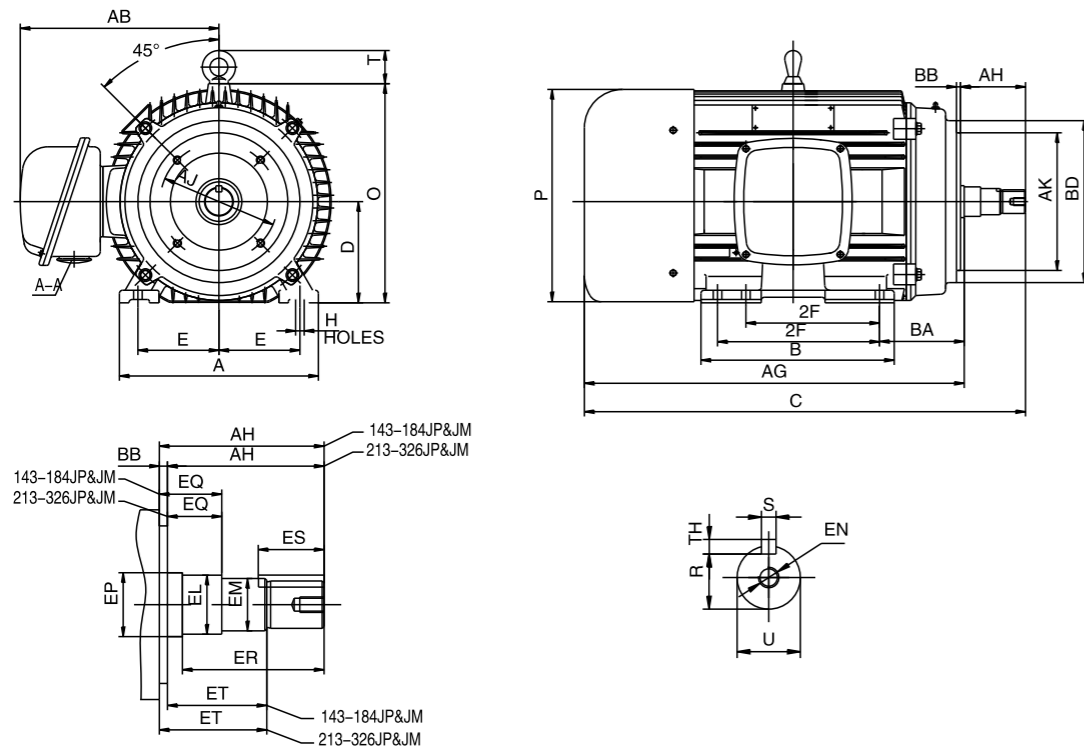

### • JM/JP Series

Frame	A	B	D	E	2F	H	O	$\Phi p$	T	AA	AB	AG	AJ	AK	BA	BB	BD
143JM/JP	6.93	4.88	3.5	2.75	4	0.34	7.57	8.15	—	NPT3/4	6.57	10.28	5.87	4.5	2.38	0.15	6.5
145JM/JP	6.93	5.87	3.5	2.75	5	0.34	7.57	8.15	—	NPT3/4	6.57	11.26	5.87	4.5	2.38	0.15	6.5
182JM/JP	8.66	5.59	4.5	3.75	4.5	0.41	9.22	9.55	1.65	NPT3/4	7.39	11.92	5.87	4.5	2.88	0.15	6.5
184JM/JP	8.66	6.11	4.5	3.75	5.5	0.41	9.22	9.55	1.65	NPT3/4	7.39	12.9	5.87	4.5	2.88	0.15	6.5
213JM/JP	10.23	6.89	5.25	4.25	5.5	0.41	10.84	11.2	1.65	NPT1	9.29	14.92	7.25	8.5	3.78	0.31	9
215JM/JP	10.23	8.39	5.25	4.25	7	0.41	10.84	11.2	1.65	NPT1	9.29	16.41	7.25	8.5	3.78	0.31	9
254JM/JP	12.12	9.84	6.25	5	8.25	0.53	12.6	12.8	2	NPT1 1/4	11.14	19.71	7.25	8.5	4.25	0.31	10
256JM/JP	12.12	11.6	6.25	5	10	0.53	12.6	12.8	2	NPT1 1/4	11.14	21.41	7.25	8.5	4.25	0.31	10
284JM/JP	12.76	11.26	7	5.5	9.5	0.53	14.94	15.75	2.36	NPT1 1/2	13.98	22.59	11	12.5	4.75	0.31	14
286JM/JP	12.76	12.76	7	5.5	11	0.53	14.94	15.75	2.36	NPT1 1/2	13.98	24.09	11	12.5	4.75	0.31	14
324JM/JP	14.88	12.68	8	6.25	10.5	0.66	16.77	17.75	2.36	NPT2	14.37	24.76	11	12.5	5.25	0.31	14
326JM/JP	14.88	14.17	8	6.25	12	0.66	16.77	17.75	2.36	NPT2	14.37	26.38	11	12.5	5.25	0.31	14
364JM/JP	16.4	14.4	9	7	11.25	0.66	18.5	19.1	2.8	NPT3	17.32	26.97	11	12.5	5.88	0.31	14
365JM/JP	16.4	15.4	9	7	12.25	0.66	18.5	19.1	2.8	NPT3	17.32	27.95	11	12.5	5.88	0.31	14

# Close-Coupled Pump Motors

Mounting and overall dimensions  
**JM, JP**

### • JM Series

Frame	EL	EM	EN	EP	EQ	ER	ES	ET	$\Phi U$	AH	TH	R	S	C
143JM	1.156	1	3/8-16X0.75	1.16	0.62	4.25	1.66	2.87	0.874	4.25	0.19	0.77	0.19	14.53
145JM	1.156	1	3/8-16X0.75	1.16	0.62	4.25	1.66	2.87	0.874	4.25	0.19	0.77	0.19	15.51
182JM	1.25	1	3/8-16X0.75	1.25	0.62	4.25	1.66	2.87	0.874	4.25	0.19	0.77	0.19	16.17
184JM	1.25	1	3/8-16X0.75	1.25	0.62	4.25	1.66	2.87	0.874	4.25	0.19	0.77	0.19	17.15
213JM	1.25	1	3/8-16X0.75	1.75	0.62	4.25	1.66	2.87	0.874	4.25	0.19	0.77	0.19	19.17
215JM	1.25	1	3/8-16X0.75	1.75	0.62	4.25	1.66	2.87	0.874	4.25	0.19	0.77	0.19	20.66
254JM	1.75	1.375	1/2-13X1	1.75	0.62	5.25	2.53	3	1.249	5.25	0.25	1.11	0.25	24.96
256JM	1.75	1.375	1/2-13X1	1.75	0.62	5.25	2.53	3	1.249	5.25	0.25	1.11	0.25	26.66
284JM	1.75	1.375	1/2-13X1	2.13	0.62	5.25	2.53	3	1.249	5.25	0.25	1.11	0.25	27.84
286JM	1.75	1.375	1/2-13X1	2.13	0.62	5.25	2.53	3	1.249	5.25	0.25	1.11	0.25	29.34
324JM	1.75	1.375	1/2-13X1	2.13	0.62	5.25	2.53	3	1.249	5.25	0.25	1.11	0.25	30.01
326JM	1.75	1.375	1/2-13X1	2.13	0.62	5.25	2.53	3	1.249	5.25	0.25	1.11	0.25	31.63

### • JP Series

Frame	EL	EM	EN	EP	EQ	ER	ES	ET	$\Phi U$	AH	TH	R	S	C
143JP	1.156	1	3/8-16X0.75	1.16	1.56	7.31	1.66	5.93	0.874	7.31	0.19	0.77	0.19	17.59
145JP	1.156	1	3/8-16X0.75	1.16	1.56	7.31	1.66	5.93	0.874	7.31	0.19	0.77	0.19	18.57
182JP	1.25	1	3/8-16X0.75	1.25	1.56	7.31	1.66	5.93	0.874	7.31	0.19	0.77	0.19	19.23
184JP	1.25	1	3/8-16X0.75	1.25	1.56	7.31	1.66	5.93	0.874	7.31	0.19	0.77	0.19	20.21
213JP	1.75	1.375	1/2-13X1	1.75	2.37	8.12	2.53	5.87	1.249	8.12	0.19	1.11	0.25	23.04
215JP	1.75	1.375	1/2-13X1	1.75	2.37	8.12	2.53	5.87	1.249	8.12	0.19	1.11	0.25	24.53
254JP	1.75	1.375	1/2-13X1	1.75	2.37	8.12	2.53	5.87	1.249	8.12	0.25	1.11	0.25	27.83
256JP	1.75	1.375	1/2-13X1	1.75	2.37	8.12	2.53	5.87	1.249	8.12	0.25	1.11	0.25	29.53
284JP	1.75	1.375	1/2-13X1	2.125	2.37	8.12	2.53	5.87	1.249	8.12	0.25	1.11	0.25	30.71
286JP	1.75	1.375	1/2-13X1	2.125	2.37	8.12	2.53	5.87	1.249	8.12	0.25	1.11	0.25	32.21
324JP	1.75	1.375	1/2-13X1	2.125	2.37	8.12	2.53	5.87	1.249	8.12	0.25	1.11	0.25	32.88
326JP	1.75	1.375	1/2-13X1	2.125	2.37	8.12	2.53	5.87	1.249	8.12	0.25	1.11	0.25	34.5
364JP	2.125	1.75	1/2-13X1	2.5	2.37	8.12	2.53	5.87	1.624	8.12	0.375	1.41	0.375	35.09
365JP	2.125	1.75	1/2-13X1	2.5	2.37	8.12	2.53	5.87	1.624	8.12	0.375	1.41	0.375	36.07

## Oil Well Pump Motors

### Applications:

Beam pumps, sucker rods pumps, other applications requiring high torque or high slip.

### Features:

Service Factor 1.15  
Design D  
High torque, high slip

Fa-mounting  
Class F Insulation  
TEFC enclosure



HP	RPM	Voltage	Frame	Catalog Number	FL Amps (A)	FL Eff. (%)	Approx. Wt. (lbs.)
3	1120	230/460/796	<b>213T</b>	OWP31	8.8/4.4/2.5	81.8	157
5	1125	230/460/796	<b>215T</b>	OWP51	14.6/7.3/4.2	82.3	177
7.5	1120	230/460/796	<b>254T</b>	OWP71	21.6/10.8/6.3	86.5	298
10	1120	230/460/796	<b>256T</b>	OWP101	29.0/14.5/8.4	86.6	322
15	1120	230/460/796	<b>284T</b>	OWP151	41.4/20.7/12.0	87.7	417
20	1120	230/460/796	<b>286T</b>	OWP201	54.0/27.0/15.6	87.7	459
25	1125	230/460/796	<b>324T</b>	OWP251	65.2/32.6/18.8	88.4	611
30	1120	230/460/796	<b>326T</b>	OWP301	78.0/39.0/22.5	88.7	668
40	1120	230/460/796	<b>365T</b>	OWP401	100/50.0/28.9	88.9	807
50	1120	230/460/796	<b>404T</b>	OWP501	123/61.5/35.5	89.9	997
60	1120	230/460/796	<b>405T</b>	OWP601	145.2/72.6/42.0	89.9	1087
75	1140	230/460/796	<b>444T</b>	OWP751	185.2/92.6/53.5	90.6	1431
100	1140	230/460/796	<b>445T</b>	OWP1001	242/121/69.9	91	1751

## Oil Well Pump Motors

### Mounting and overall dimensions

### 213-445T

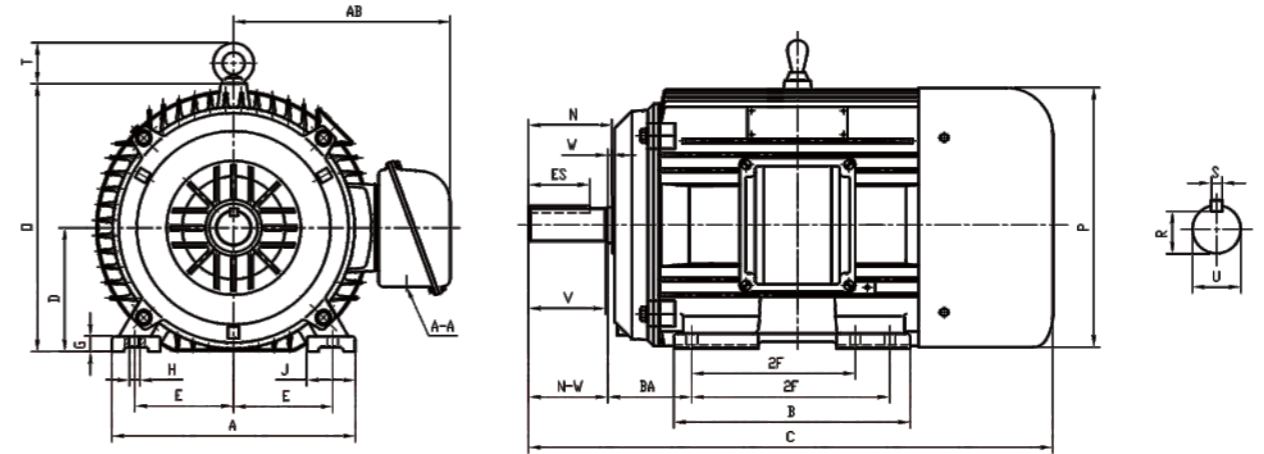

TYPE	A	B	C	D	E	2F	G	H	J	O	P	R	S	T	U	Vmin	ESmin	AA	AB	BA	N	N-W
143T/145T	7	6	14.3	3.5	2.75	4/5	0.52	0.34 Hole	1.58	7.52	6.89	0.771	0.188	1.42	0.875	2	1.41	3/4	6.36	2.25	2.44	2.25
182T/184T	9	7.3	17.3	4.5	3.75	4.5/5.5	0.67	0.41 Hole	1.97	9.83	8.66	0.986	0.25	1.73	1.125	2.5	1.78	3/4	7.66	2.75	2.99	2.75
213T/215T	10.5	9.4	21.2	5.25	4.25	5.5/7	0.73	0.41 Hole	2.2	11.62	10.87	1.201	0.312	2.05	1.375	3.12	2.41	1	8.65	3.5	3.65	3.38
254T/256T	12.3	12	26.5	6.25	5.0	8.25/10	0.79	0.53 Hole	2.44	13.8	12.33	1.416	0.375	2.05	1.625	3.75	2.91	1-1/4	11.26	4.25	4.4	4
284T/286T	13.8	13.6	28.8	7	5.5	9.5/11	0.87	0.53 Hole	2.84	15.6	14.22	1.591	0.5	2.44	1.875	4.38	3.28	1-1/2	12.98	4.75	5.02	4.62
284TS/286TS	13.8	13.6	27.1	7	5.5	9.5/11	0.87	0.53 Hole	2.84	15.6	14.22	1.416	0.375	2.44	1.625	3	1.91	1-1/2	12.98	4.75	5.02	3.25
324T/326T	15.3	14.1	31.5	8	6.25	10.5/12	1.03	0.66 Hole	2.95	17.32	15.67	1.845	0.5	2.44	2.125	5	3.91	2	14.55	5.25	5.25	5.25
324TS/326TS	15.3	14.1	30	8	6.25	10.5/12	1.03	0.66 Hole	2.95	17.32	15.67	1.591	0.5	2.44	1.875	3.5	2.03	2	14.55	5.25	5.65	3.75
364T/365T	17.2	16.2	34.5	9	7	11.25/12.25	1.1	0.66 Hole	3.23	18.98	17.6	2.021	0.625	2.44	2.375	5.62	4.28	3	15.56	5.88	6.28	5.88
364TS/365TS	17.2	16.2	32.02	9	7	11.25/12.25	1.1	0.66 Hole	3.23	18.98	17.6	1.591	0.5	2.44	1.875	3.5	2.03	3	15.56	5.88	6.28	3.75
404T/405T	19.22	20	37.6	10	8	12.25/13.75	1.2	0.81 Hole	3.35	20.96	19.15	2.45	0.75	2.84	2.875	7	5.65	3	17.37	6.62	7.28	7.25
404TS/405TS	19.22	20	34.6	10	8	12.25/13.75	1.2	0.81 Hole	3.35	20.96	19.15	1.845	0.5	2.84	2.215	4	2.78	3	17.37	6.62	7.73	4.25
444T/445T	21.76	21.26	42.5	11	9	14.5/16.5	1.2	0.81 Hole	3.74	23.5	21.57	2.88	0.875	4.1	3.375	8.25	6.91	3	19.87	7.5	8.98	8.5
444TS/445TS	21.76	21.26	38.75	11	9	14.5/16.5	1.2	0.81 Hole	3.74	23.5	21.57	2.021	0.625	4.1	2.375	4.5	3.03	3	19.87	7.5	8.98	4.75
447T/449T	21.76	28.74	53.55	11	9	20/25	1.2	0.81 Hole	3.74	23.5	23.35	2.88	0.875	4.1	3.375	8.25	6.91	3	20.87	7.5	8.98	8.5
447TS/449TS	21.76	28.74	49.8	11	9	20/25	1.2	0.81 Hole	3.74	23.5	23.35	2.021	0.625	4.1	2.375	4.5	3.03	3	20.87	7.5	8.98	4.75

# Stainless Steel Motors

## Applications:

Food processing, packaging, outdoor, and highly corrosive environments

## Features:

- C Face
- Design B
- Class F Insulation
- Four condensate drains in each endplate
- All external surfaces 300 series stainless steel, frame, end plates, conduit box, shaft and base
- Service Factor 1.15
- TEFC enclosure
- Lip seals



HP	RPM	Voltage	Frame	Catalog Number		FL Eff %	FL Amps 460V	Ship WT. (lbs.)	Note
				Footed	Footless				
0.3	1800	208-230/460V	56C	SS13401	SS13411	0.6	79.8	41	TENV
	3600	208-230/460V	56C	SS12201	SS12211	0.84	78.3	42	TENV
0.5	1800	208-230/460V	56C	SS12401	SS12411	0.87	81.2	48	TENV
	1200	208-230/460V	56C	SS12601	SS12611	0.91	79.1	63	TENV
0.75	3600	208-230/460V	56C	SS34201	SS34211	1.17	81.9	47	TENV
	1800	208-230/460V	56C	SS34401	SS34411	1.25	81.3	53	TENV
1	1200	208-230/460V	56C	SS34601	SS34611	1.29	82.9	68	TENV
	3600	208-230/460V	56C	SS1201	SS1211	1.48	83.3	58	
1	1800	208-230/460V	56C	SS1401	SS1411	1.58	82.3	60	
	1800	208-230/460V	56C	SS1402	SS1412	1.5	82.3	60	TENV
	1800	208-230/460V	143TC	SS1403	SS1413	1.5	82.5	75	
	1800	208-230/460V	143TC	SS1404	SS1414	1.5	82.5	75	TENV
1.5	3600	208-230/460V	56C	SS32201	SS32211	2.05	82.3	64	
	3600	208-230/460V	143TC	SS32202	SS32212	2	82.5	72	
	1800	208-230/460V	56C	SS32401	SS32411	2.01	82	65	
	1800	208-230/460V	145TC	SS32402	SS32412	2.2	84	70	
2	3600	208-230/460V	56C	SS2201	SS2211	2.62	83	73	
	3600	208-230/460V	145TC	SS2202	SS2212	2.7	84	82	
	1800	208-230/460V	56C	SS2401	SS2411	2.69	85	78	
	1800	208-230/460V	145TC	SS2402	SS2412	2.8	84	80	
3	3600	208-230/460V	145TC	SS3201	SS3211	3.8	84	90	
	3600	208-230/460V	182TC	SS3202	SS3212	3.8	85.5	95	
5	1800	208-230/460V	182TC	SS3401	SS3411	3.9	87.5	102	
	3600	208-230/460V	184TC	SS5201	SS5211	6.1	87.5	116	
7.5	1800	208-230/460V	184TC	SS5401	SS5411	6.5	87.5	130	
	3600	208-230/460V	213TC	SS7201	SS7211	8.9	88.5	175	
10	1800	208-230/460V	213TC	SS7401	SS7411	9.4	89.5	190	
	3600	208-230/460V	215TC	SS10201	SS10211	11.8	89.5	202	
10	1800	208-230/460V	215TC	SS10401	SS10411	12.5	90.2	207	

## Stainless Steel Motors

### Mounting and overall dimensions 56C-215TC

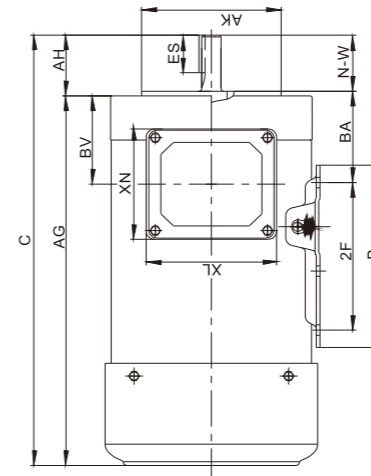
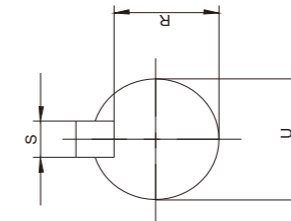
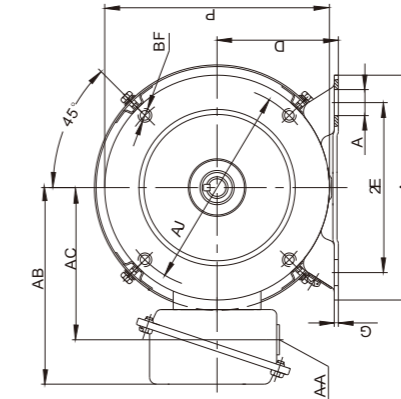

Frame	Mounting				Conduit Box				Motor Dimensions				Keyseat				Bearings				Enclos.				
	D	E	2F	A	B	BA	H	AB	AC	XL	XN	AA	C	AH	AJ	AK	P	N-W	U	R		S	ES	ODE	DE
56C	3.5	2.44	3.0	6.5	6.5	2.75	1.22X.34	5.75	4.25	4.72	3.80	0.86	11.59	2.06	5.875	4.5	6.5	1.88	0.625	0.517	0.188	1.41	6205Z	6205Z	TEFC
143TC	3.5	2.75	4.0	6.5	6.5	2.75	1.22X.34	5.75	4.25	4.72	3.80	0.86	12.63	2.12	5.875	4.5	6.5	1.88	0.625	0.517	0.188	1.41	6205Z	6205Z	TEFC
145TC	3.5	2.75	4.0	6.5	6.5	2.75	1.22X.34	5.75	4.25	4.72	3.80	0.86	13.68	2.12	5.875	4.5	6.5	2.25	0.875	0.771	0.188	1.41	6205Z	6205Z	TEFC
182TC	4.5	3.75	4.5	8.8	6.5	3.50	0.71X.47	7.00	5.30	4.45	4.05	0.94	16.40	2.62	7.250	8.5	8.9	2.75	1.125	0.986	0.250	1.78	6307Z	6308Z	TEFC
184TC	4.5	3.75	4.5	8.8	6.5	3.50	0.71X.47	7.00	5.30	4.45	4.05	0.94	16.40	2.62	7.250	8.5	8.9	2.75	1.125	0.986	0.250	1.78	6307Z	6308Z	TEFC
213TC	5.25	4.25	5.5	10	8.5	4.25	0.71X.47	7.60	6.20	4.45	4.05	0.94	21.50	3.12	7.250	8.5	10	3.38	1.375	1.201	0.312	2.41	6308Z	6308Z	TEFC
215TC	5.25	4.25	7.0	10	8.5	4.25	0.71X.47	7.60	6.20	4.45	4.05	0.94	22.30	3.12	7.250	8.5	10	3.38	1.375	1.201	0.312	2.41	6308Z	6308Z	TEFC

## Air Compressor Motors

### Applications:

Design for single phase air compressor load or other applications having similar load.

### Features:

- Rigid Base
- ODP Enclosure
- Ball Bearing
- Class B
- Maximum 40C ambient temperature
- Manual Reset Thermal Over load Protector,5hp None

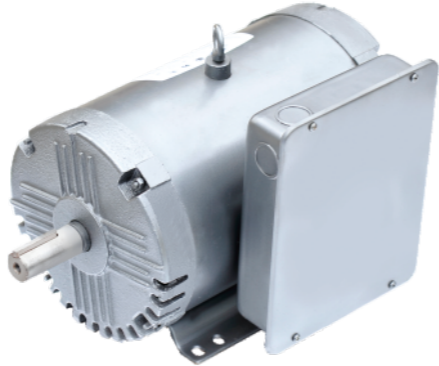

HP	RPM	Voltage	Frame	Catalog Number	Full load Amps	Service factor	Overload protector
1.5	3600	115/230	56	A843	22.0/11.0	1	Manual
2	3600	115/230	56	A874	24.0/12.0	1	Manual
3	3600	230	56	A867	15	1	Manual
5	3600	208-230	182T	A976	22	1.15	Manual
7.5	3600	208-230	184T	A1057	34.3-31.0	1.15	None

## Mounting and overall dimensions 56T-184T

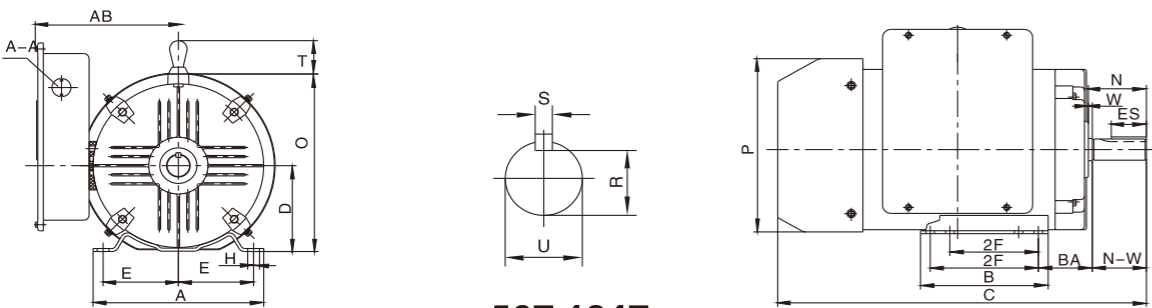

**56T-184T**

Frame size	AB	BA	MAX A	MAX B	C	D	E	2F	H	N	N-W	O	P	R	S	U	MIN V	MIN ES	MIN AA	
56	5.6	2.75	6.5	4.2	12.7	3.5	2.44	3	0.34	2.4	1.88	6.7	7.08	0.517	0.188	0.625	1.5	1.41	1/2	
143T								4												
145T	5.6	2.25	7	6.18	14.6	3.5	2.75	5	0.34	2.46	2.25	6.7	7.08	0.771	0.188	0.875	2	1.41	3/4	
182T								4.5												
184T	7.2	2.75	8.5	6.5	18.8	4.5	3.75	5.5	0.41	2.98	2.75	9.25	9.25	0.986	0.25	1.125	2.5	1.78	3/4	

## 48 SQUARE Flange Swimming Pool Motors

### Applications:

Can be used on home water systems

### Features:

- Open dripproof(ODP)
- 3023 stainless steel shaft
- Voltage selection device
- Thermally protectde
- Sealed ball bearings
- Class F
- 50°C ambient
- high SF



High Service Factor(Full Rated )											
HP	RPM	Volts	Hz	Service Factor Amps	service Factor	Frame	JLEM Catalog Number	shaft	Overload Protector	A dimension	Notes
1/2	3450	115/230	60	13.4/ 6.7	1.90	48Y	SPY12A11	Threaded	Auto	11 1/2	
3/4	3450	115/230	60	15.3/ 7.6	1.65	48Y	SPY34A11	Threaded	Auto	12 1/8	
1	3450	115/230	60	19.2/ 9.6	1.65	48Y	SPY01A11	Threaded	Auto	13 1/8	
11/2	3450	230	60	10.4	1.47	48Y	SPY32A11	Threaded	Auto	13 1/4	
2	3450	230	60	11.2	1.30	48Y	SPY02A11	Threaded	Auto	13 7/8	
3	3450	230	60	15.4	1.15	48Y	SPY03A11	Threaded	Auto	14	

Low Service Factor(Up Rated )											
HP	RPM	Volts	Hz	Service Factor Amps	service Factor	Frame	JLEM Catalog Number	shaft	Overload Protector	A dimension	Ship Wt (lbs)
1/2	3450	115/ 230	60	9.9/ 5.0	1.30	48Y	SPY12A01	Threaded	Auto	11 1/8	19
3/4	3450	115/ 230	60	13.4/ 6.7	1.27	48Y	SPY34A01	Threaded	Auto	11 1/2	21
1	3450	115/ 230	60	15.3/ 7.6	1.25	48Y	SPY01A01	Threaded	Auto	12 1/8	24
11/2	3450	230	60	19.2/ 9.6	1.10	48Y	SPY32A01	Threaded	Auto	13 1/8	26
2	3450	230	60	10.4	1.10	48Y	SPY02A01	Threaded	Auto	13 1/4	29
2 1/2	3450	230	60	11.2	1.10	48Y	SPY03A01	Threaded	Auto	13 7/8	32

## 56C FLANGE 5.5" Body Swimming Pool Motors

### Applications:

Can be used on home water systems

### Features:

- Open dripproof(ODP)
- 3023 stainless steel shaft
- Voltage selection device
- Thermally protectde
- Sealed ball bearings
- Class F
- 50°C ambient
- high SF



## 56 SQUARE Flange Swimming Pool Motors

### Applications:

Can be used on home water systems

### Features:

- Open dripproof(ODP)
- 3023 stainless steel shaft
- Voltage selection device
- Thermally protectde
- Sealed ball bearings
- Class F
- 50°C ambient
- high SF



High Service Factor(Full Rated )											
HP	RPM	Volts	Hz	Service Factor Amps	service Factor	Frame	JLEM Catalog Number	shaft	Overload Protector	"C" dimension	Notes
1/2	3450	115/230	60	10.6/5.3	1.60	56C	SPC12A11	Keyed	Auto	11	19
		115/230	60	11.0/5.5	1.60	56J	SPJ12A11	Threaded	Auto	10 5/8	19
3/4	3450	115/230	60	14.6/7.3	1.50	56C	SPC34A11	Keyed	Auto	11 9/16	20
		115/230	60	15.0/7.5	1.50	56J	SPC34A11	Threaded	Auto	11	20
1	3450	115/230	60	17.0/8.5	1.50	56C	SPC01A11	Keyed	Auto	12 1/8	22
		115/230	60	18.6/9.3	1.50	56J	SPJ01A11	Threaded	Auto	12 1/8	22
11/2	3450	115/230	60	19.4/9.7	1.30	56C	SPC21A11	Keyed	Auto	12 7/8	24
		115/208-230	60	19.6/10.4-9.8	1.30	56J	SPJ32A11	Threaded	Auto	12 7/8	24
2	3450	115/230	60	11.2	1.30	56C	SPC02A11	Keyed	Auto	13 1/16	27
		115/208-230	60	12.6-11.4	1.30	56J	SPJ02A11	Threaded	Auto	13 1/16	27
3	3450	115/230	60	14.4	1.15	56C	SPC03A11	Keyed	Auto	13 5/8	30
		115/208-230	60	14.5-13.8	1.15	56J	SPJ03A11	Threaded	Auto	14 3/16	30

Low Service Factor(Up Rated )											
HP	RPM	Volts	Hz	Service Factor Amps	service Factor	Frame	JLEM Catalog Number	shaft	Overload Protector	"C" dimension	Ship Wt (lbs)
3/4	3450	115/230	60	11.0/5.5	1.00	56J	SPJ34A01	Threaded	Auto	10 5/8	18
1	3450	115/230	60	15.0/7.5	1.00	56J	SPJ01A01	Threaded	Auto	11	20
11/2	3450	115/230	60	18.6/9.3	1.00	56J	SPJ32A01	Threaded	Auto	12 1/8	22
2	3450	115/208-230	60	19.6/10.4-9.8	1.00	56J	SPJ02A01	Threaded	Auto	12 5/8	25
21/2	3450	115/230	60	12.6/11.4	1.00	56J	SPJ03A01	Threaded	Auto	13 1/16	27

HP	RPM	Volts	Service Factor Amps	service Factor	Frame	JLEM Catalog Number	shaft	Overload Protector	"C" dimension	Ship Wt (lbs)
3/4	3450	115/208-230	6.5-5.6/11.2	1.67	56Y	SPY34B01	Threaded	Auto	13.1	22
1	3450	115/208-230	7.8-7.4/14.8	1.65	56Y	SPY01B01	Threaded	Auto	13.4	25
1-1/2	3450	208-230	9.6-8.8	1.47	56Y	SPY32B01	Threaded	Auto	13.9	26
2	3450	208-230	11.0-10.2	1.30	56Y	SPY02B01	Threaded	Auto	14.4	33
3	3450	208-230	15.0-13.6	1.15	56Y	SPY03B01	Threaded	Auto	14.4	40

## 56C FLANGE 6.5" Body Swimming Pool Motors

### Applications:

Can be used on home water systems

### Features:

- Open dripproof(ODP)
- 3023 stainless steel shaft
- Voltage selection device
- Thermally protectde
- Sealed ball bearings
- Class F
- 50°C ambient
- high SF



HP	RPM	Volts	Hz	Service Factor Amps	service Factor	Frame	JLEM Catalog Number	shaft	Overload Protector	"C" dimension	Ship Wt (lbs)
3/4	3450	230/115	60	6.0/12.0	1.50	56C	SPC34B01	Keyed	Auto	11.44	21
	3450	230/115	60	6.0/12.0	1.50	56J	SPJ34B01	Threaded	Auto	12.01	21
1	3450	230/115	60	7.2/14.4	1.40	56C	SPC01B01	Keyed	Auto	11.89	24
	3450	230/115	60	7.2/14.4	1.40	56J	SPJ01B01	Threaded	Auto	12.14	24
1 1/2	3450	230/115	60	9.2/18.4	1.30	56C	SPC32B01	Keyed	Auto	13.19	25
	3450	230/115	60	9.2/18.4	1.30	56J	SPJ32B01	Threaded	Auto	13.50	25
2	3450	230/115	60	10.8/21.6	1.20	56C	SPC02B01	Keyed	Auto	13.94	31
	3450	230	60	10.5	1.20	56C	SPC02B01	Keyed	Auto	12.55	31
	3450	230/115	60	10.8/21.6	1.20	56J	SPJ02B01	Threaded	Auto	13.90	31
	3450	230	60	10.5	1.20	56J	SPJ02B01	Threaded	Auto	13.10	31
3	3450	230	60	14.1	1.15	56C	SPC03B01	Keyed	Auto	13.65	39
	3450	230	60	14.1	1.15	56J	SPJ03B01	Threaded	Auto	14.15	39

## Farm Duty Single Phase Motors

### Applications:

General agricultural applications like live stock , crops,dairy,poultry.

### Features:

- Over 300% Starting Torque
- Manual overload protection
- Reversible rotation
- Rolled Steel frames , Rigid based
- Totally Enclosed Fan Cooled - TEFC ,Ip55
- Class F insulation
- FI Assembly
- Die cast aluminum end cap



HP	RPM	Voltage	Frame	Catalog Number	SF	Full load Amps	Manual Overload Protector	Ship WT (lbs.)
1/3	1800	115/230	56	FH13401	1.15	6.2/3.1	Yes	20
1/2	1800	115/230	56	FH12401	1.15	8.0/4.0	Yes	20
3/4	1800	115/230	56	FH34401	1.15	10.8/5.4	Yes	20
1	1800	115/230	143T	FH1401	1.00	15.0/7.5	Yes	48
	1800	115/230	56H	FH1402	1.15	14.4/7.2	Yes	20
1-1/2	1800	115/230	145T	FH32401	1.15	16.2/8.1	Yes	41
	1800	115/230	56H	FH32402	1.15	16.2/8.1	Yes	24
2	1800	115/230	182T	FH2401	1.00	23.6/11.8	Yes	60
	1800	115/230	56Hz	FH2402	1.00	20.0/10.0	Yes	40
3	1800	230	184T	FH3401	1.00	14.5	Yes	74
5	1800	230	184T	FH5401	1.00	22.0	Yes	85
	1800	230	213T	FH5402	1.00	23.0	No	80
7-1/2	1800	230	215T	FH7401	1.00	30.0	No	147
10	1800	230	215T	FH10401	1.00	38.0	No	180

## Farm Duty Single Phase Motors

### Mounting and overall dimensions:

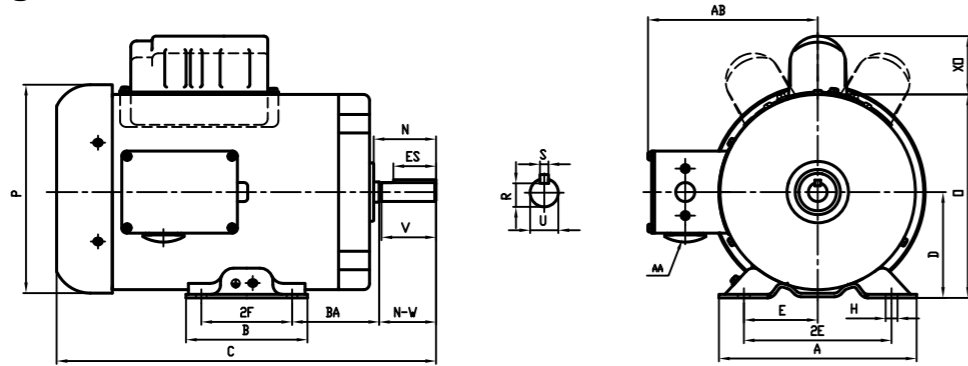

48-56T

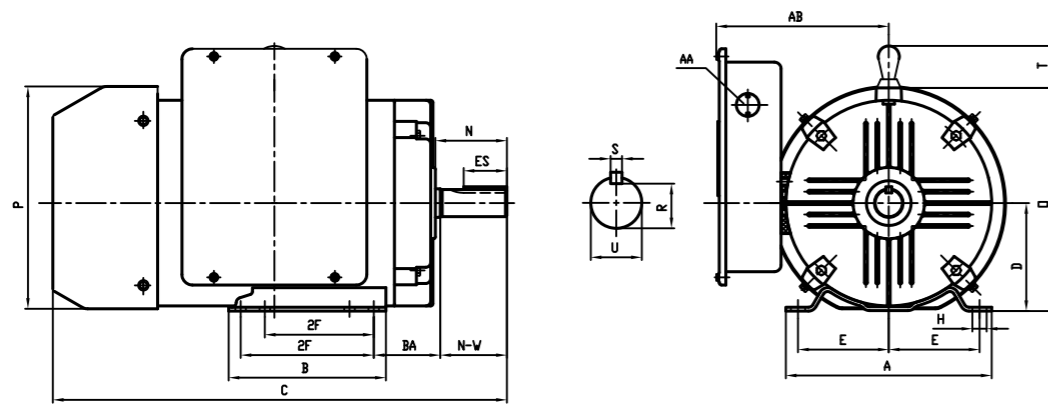

180-210T

Frame size	AB	BA	MAX A	MAX B	MAX C	D	E	2F	H	N	N-W	O	P	R	S	U	MIN V	MIN ES	MIN AA
56	5.6	2.75	6.5	4.2	14.6	3.5	2.44	3	0.34	2.4	1.88	6.7	7.08	0.517	0.188	0.625	1.5	1.41	1/2
56H	5.6	2.75	6.5	6.5	14.6	3.5	2.44	5	0.34	2.13	1.88	6.7	7.08	0.517	0.188	0.625	1.5	1.41	1/2
143T	5.6	2.25	7	6.18	14.6	3.5	2.75	4	0.34	2.46	2.25	6.7	7.08	0.771	0.188	0.875	2	1.41	3/4
145T	5.6	2.25	7	6.18	14.6	3.5	2.75	5	0.34	2.46	2.25	6.7	7.08	0.771	0.188	0.875	2	1.41	3/4
182T	7.2	2.75	8.5	6.5	18.8	4.5	3.75	4.5	0.41	2.98	2.75	9.25	9.25	0.986	0.25	1.125	2.5	1.78	3/4
184T	7.2	2.75	8.5	6.5	18.8	4.5	3.75	5.5	0.41	2.98	2.75	9.25	9.25	0.986	0.25	1.125	2.5	1.78	3/4
213T	7.5	3.5	9.5	8	20.5	5.25	4.25	5.5	0.41	3.66	3.38	9.84	10.7	1.201	0.312	1.375	3.12	2.41	1
215T	7.5	3.5	9.5	8	20.5	5.25	4.25	7.0	0.41	3.66	3.38	9.84	10.7	1.201	0.312	1.375	3.12	2.41	1

## Belted Fan & Blower Motors

### Applications:

Belted fan, air conditioner units, Ventilators, band saws and farm equipment.

### Features:

- Open drip proof (ODP)
- Class F Insulation
- Reversible Rotation
- Resilient Cradle
- 40°C Ambient
- Auto Thermal protector



### Single Phase Motors

HP	RPM	Voltage	Frame	Catalog Number	SF	Full load Amps	Manual Overload Protector	Ship WT. (lbs.)
1/4	1725	115/208-230	48	BF14S401	4.2/2.1	500	1.35	18
1/3	1725	115/208-230	48	BF13S401	6.0/3.0	500	1.35	20
1/2	1725	115/208-230	56	BF12S401	7.4/3.7	625	1.25	22
3/4	1725	115/208-230	56	BF34S401	11.4/5.7	625	1.25	27
1	1725	115/208-230	56	BF1S401	14.0/7.0	625	1.25	30
1-1/2	1725	115/208-230	56	BF32S401	22.4/11.2	625	1.15	35
2	1725	115/208-230	56	BF2S401	26.0/13.0	625	1.15	43

Single Phase Motors • Premium efficient Motors • High efficient Motors • C Face Motors • Severe Duty Motors • IEEE-841 Motors • Explosion Proof Motors • Special Purpose Motors • Farm Duty Single Phase Motors • Belted Fan & Blower Motors • Single Phase Auger Motors

Single Phase Motors • Premium efficient Motors • High efficient Motors • C Face Motors • Severe Duty Motors • IEEE-841 Motors • Explosion Proof Motors • Special Purpose Motors • Farm Duty Single Phase Motors • Belted Fan & Blower Motors • Single Phase Auger Motors



## Belted Fan & Blower Motors

### Mounting and overall dimensions:

#### Single Phase Motors

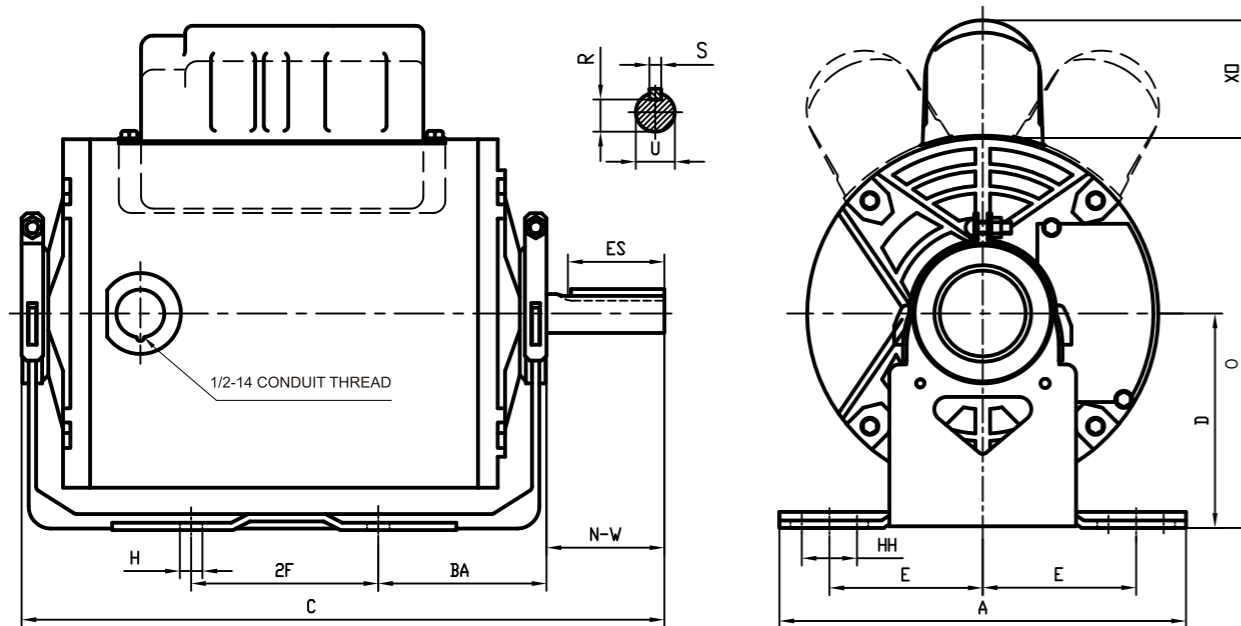

HP	BA	A	C	D	E	2F	N-W	H	HH	O	R	S	U	ES min
1/4	2.5	5.7	11	3	2.12	2.75	1.5	0.34	0.63	5.83	0.453	flat	0.5	1
1/3	2.5	5.7	11	3	2.12	2.75	1.5	0.34	0.63	5.83	0.453	flat	0.5	1
1/2	2.75	6.5	11	3.5	2.44	3	1.88	0.34	0.88	6.7	0.517	0.188	0.625	1.35
3/4	2.75	6.5	11	3.5	2.44	3	1.88	0.34	0.88	6.7	0.517	0.188	0.625	1.35
1	2.75	6.5	11	3.5	2.44	3	1.88	0.34	0.88	6.7	0.517	0.188	0.625	1.35
1-1/2	2.75	6.5	12.2	3.5	2.44	3	1.88	0.34	0.88	6.7	0.517	0.188	0.625	1.35
2	2.75	6.5	13.9	3.5	2.44	3	1.88	0.34	0.88	6.7	0.517	0.188	0.625	1.35

## Belted Fan & Blower Motors

### Three Phase Motors

HP	RPM	Voltage	Frame	Catalog Number	Amps	Shaft Dia	SF	Ship WT. (lbs.)
1/4	1725	208/230-460	48	BF14T401	1.4/0.75	.500	1.35	17
1/3	1725	208/230-460	48	BF13T401	1.6/0.8	.500	1.35	18
1/2	1725	208/230-460	56	BF12T401	2.2/1.1	.625	1.35	20
3/4	1725	208/230-460	56	BF34T401	2.9/1.5	.625	1.25	22
1	1725	208/230-460	56	BF1T401	4.3/2.2	.625	1.25	26
1-1/2	1725	208/230-460	56	BF32T401	5.2/2.6	.625	1.15	32
2	1725	208/230-460	56	BF2T401	6.3/3.1	.625	1.15	41

### Mounting and overall dimensions:

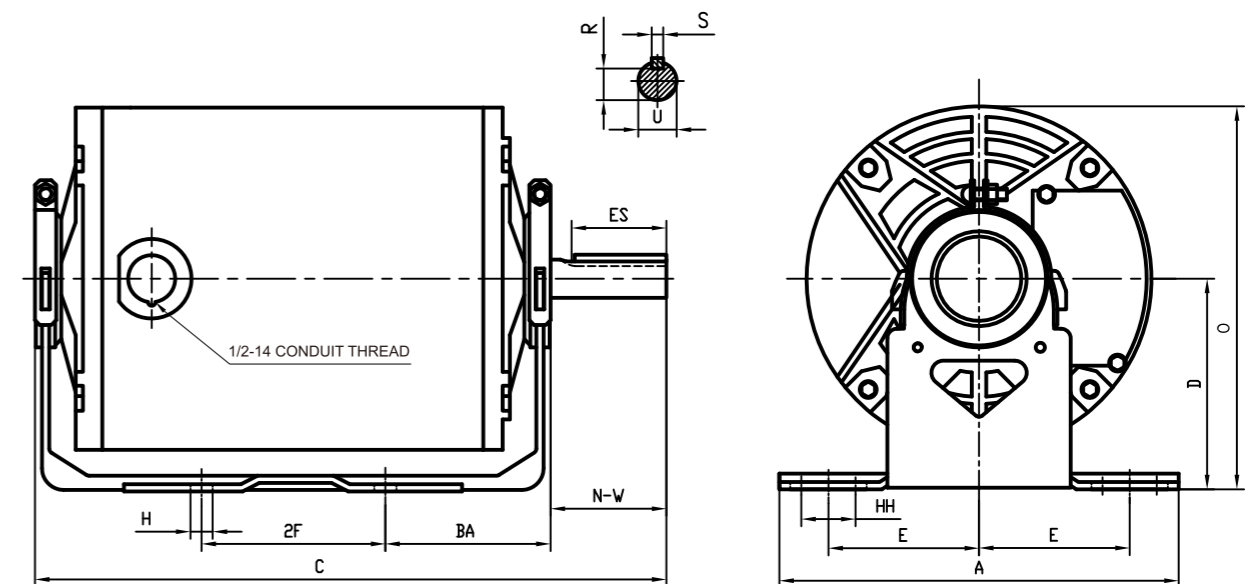

HP	BA	A	C	D	E	2F	N-W	H	HH	O	R	S	U	ES min
1/4	2.5	5.7	11	3	2.12	2.75	1.5	0.34	0.63	5.83	0.453	flat	0.5	1
1/3	2.5	5.7	11	3	2.12	2.75	1.5	0.34	0.63	5.83	0.453	flat	0.5	1
1/2	2.75	6.5	11	3.5	2.44	3	1.88	0.34	0.88	6.7	0.517	0.188	0.625	1.35
3/4	2.75	6.5	11	3.5	2.44	3	1.88	0.34	0.88	6.7	0.517	0.188	0.625	1.35
1	2.75	6.5	11	3.5	2.44	3	1.88	0.34	0.88	6.7	0.517	0.188	0.625	1.35
1-1/2	2.75	6.5	12.2	3.5	2.44	3	1.88	0.34	0.88	6.7	0.517	0.188	0.625	1.35
2	2.75	6.5	13.9	3.5	2.44	3	1.88	0.34	0.88	6.7	0.517	0.188	0.625	1.35

# Single Phase Auger Motors

**Applications:**

Poultry feed auger drive systems.

**Features:**

- High Overload Capacity
- Reversible rotation
- Manual reset thermal overload protector
- ODE shaft extension for hand cranking
- Totally enclosed fan cooled TEFC
- Ball bearings
- Class F insulation
- 56Y are keyed; 56YZ are flat shaft



HP	RPM	Voltage	Frame	Catalog Number	SF	Ship WT. (lbs.)	Amps (230V)
1/3	1800	115/208-230	56YZ	AG1341	1.0	21	3.3
1/2	1800	115/208-230	56YZ	AG1241	1.0	23	4.3
3/4	1800	115/208-230	56YZ	AG3441	1.0	32	5.7
1	1800	115/208-230	56Y	AG141	1.15	36	7.0
1-1/2	1800	115/208-230	56HY	AG3241	1.15	45	8.1

# Single Phase Auger Motors

**Mounting and overall dimensions:**

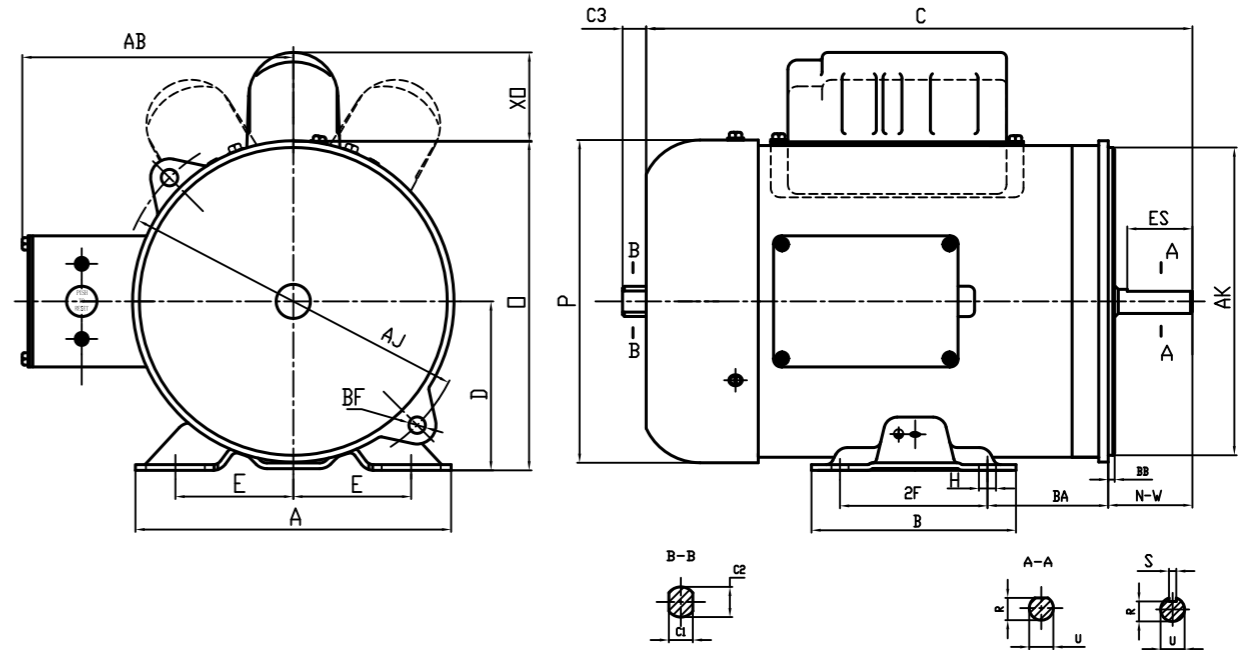

HP	HP	AB	BA	A MAX	B MAX	C MAX	D	E	2F	H	N-W	O	XO	P	R	S	U	ES MIN	AK	AJ	BF	C1	C2	C3
56YZ	1/3	5.59	2.5	6.54	4.2	11.2	3.5	2.44	3	0.34	1.75	6.7	1.89	7.08	0.453	flat	0.5	1.35	6.375	7.25	0.34	0.5	0.625	0.488
56YZ	1/2	5.59	2.5	6.54	4.2	11.2	3.5	2.44	3	0.34	1.75	6.7	1.89	7.08	0.453	flat	0.5	1.35	6.375	7.25	0.34	0.5	0.625	0.488
56YZ	3/4	5.59	2.5	6.54	4.2	12.4	3.5	2.44	3	0.34	1.75	6.7	1.89	7.08	0.453	flat	0.5	1.35	6.375	7.25	0.34	0.5	0.625	0.488
56Y	1	5.59	2.5	6.54	4.2	12.8	3.5	2.44	3	0.34	2.13	6.7	1.89	7.08	0.517	0.188	0.625	1.35	6.375	7.25	0.34	0.5	0.625	0.488
56HY	1-1/2	5.59	2.75	6.54	6.5	14.2	3.5	2.44	5	0.34	2.13	6.7	1.89	7.08	0.517	0.188	0.625	1.35	6.375	7.25	0.34	0.5	0.625	0.488